

## **Section 2**

# **TF System® Thermo-Form Components**

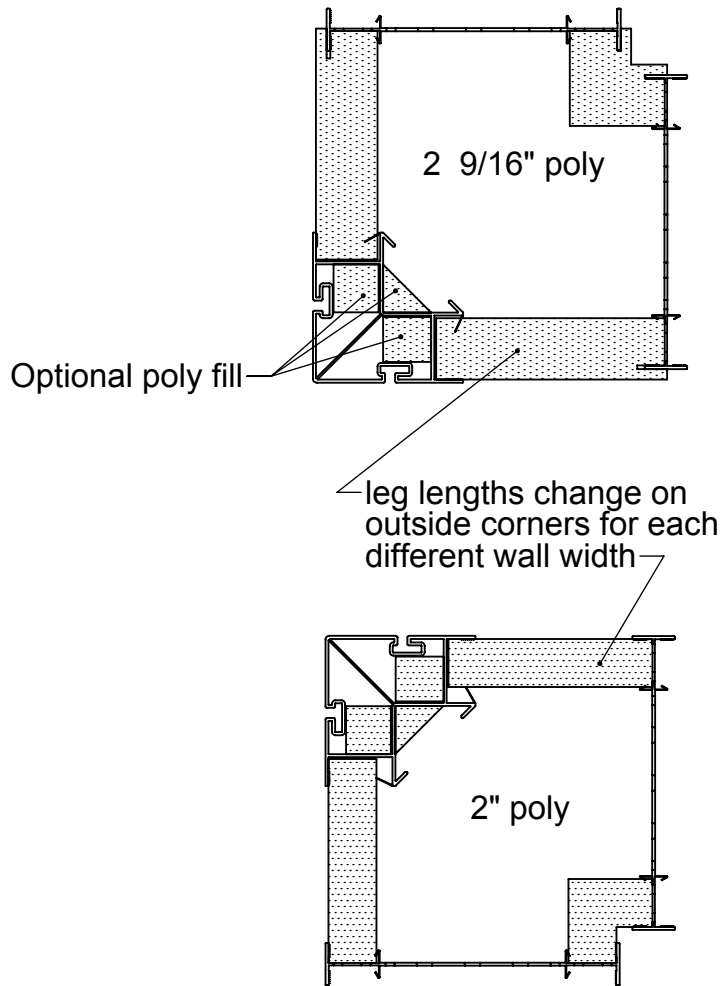

**all outside corners must be braced - see corner bracing details on pages 44 & 45**

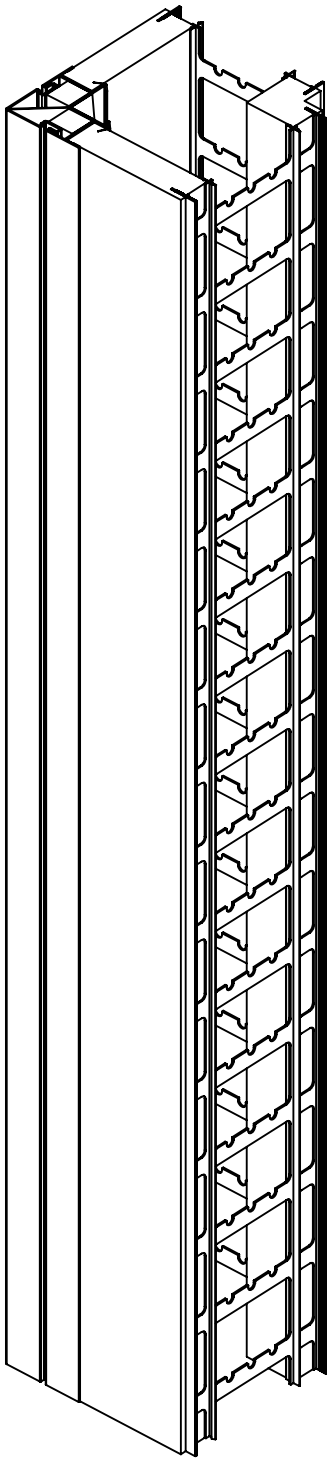

**see next page for corner set dimensions**

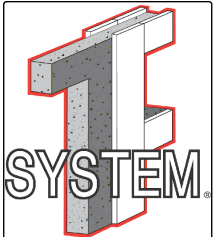

Standard Corner Sets

TF System®  
800-360-4634  
www.TFSystem.com

Date: 9/24/2009

Page Number: 9

# Thermo-Form Corner Set Dimensions

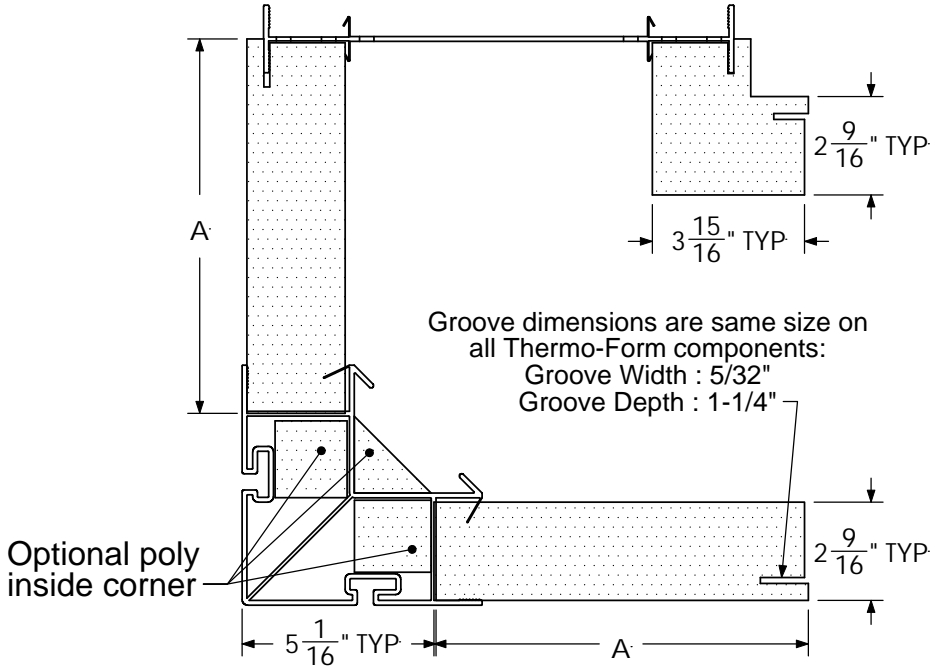
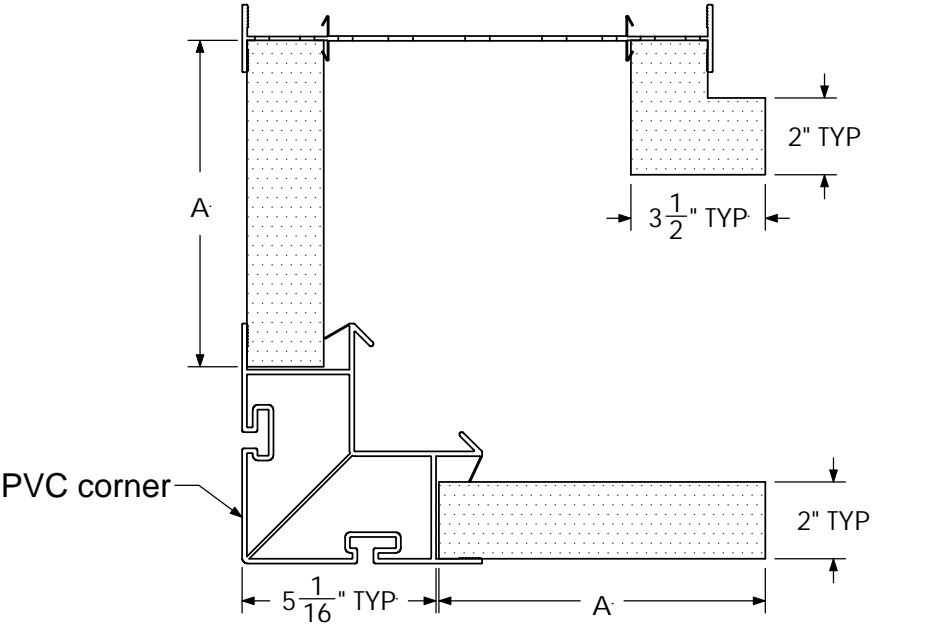
	Nominal System Width	Typical Length of Outside Leg (A)	
2-1/2" Corner Sets	6"	7 3/4"	 <p>Optional poly inside corner</p> <p>Groove dimensions are same size on all Thermo-Form components: Groove Width : 5/32" Groove Depth : 1-1/4"</p>
	8"	9 3/4"	
	10"	11 3/4"	
	12"	13 1/8"	
2" Corner Sets	6"	6 1/2"	 <p>PVC corner</p>
	8"	8 1/2"	
	10"	10"	
	12"	11 7/8"	



PVC 90° corner sets

TF System®  
800-360-4634  
www.TFSystem.com

Date: 12/22/2009

Page Number: 10

# TF System® 2" Poly Corner Set Dimensions

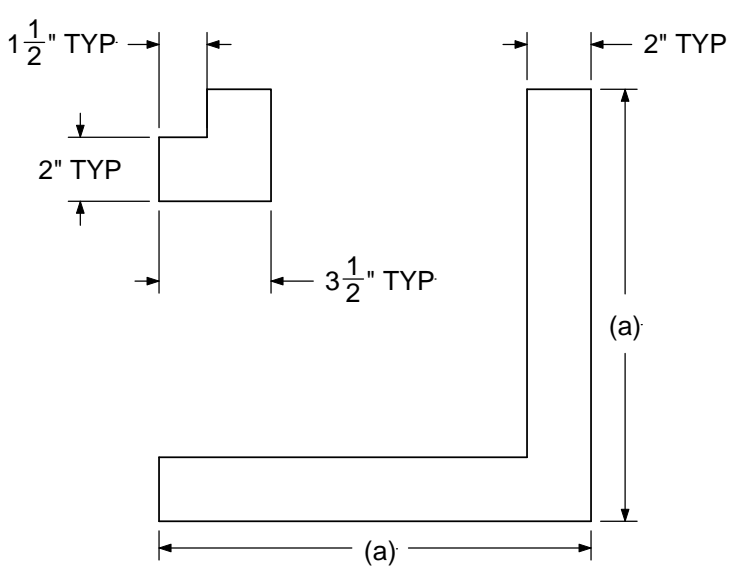
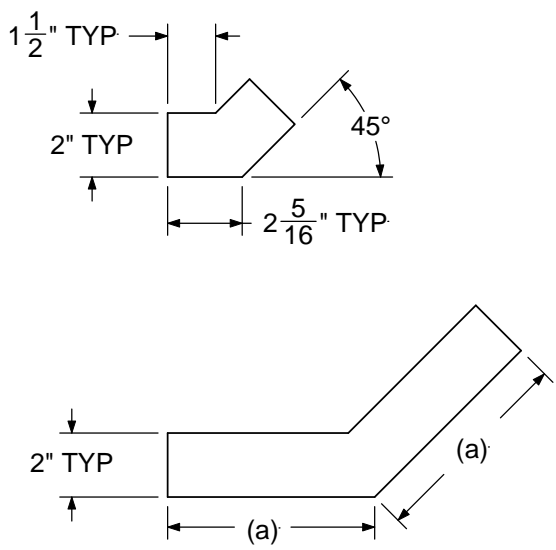
	System Width	Typical Length of Outside Leg (a)	Specialty corner sets for any angle can be ordered
90° Corner Sets	6"	11 1/2"	
	8"	13 1/2"	
	10" NOMINAL	15"	
	12" NOMINAL	16 7/8 "	
45° Corner Sets	6"	5 5/8"	
	8"	6 1/2"	
	10" NOMINAL	7 1/16"	
	12" NOMINAL	7 7/8"	

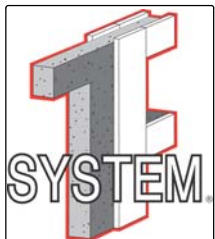

**Polystyrene Corner Sets**

**2" Thick**

TF System®  
3030C Holmgren Way  
Green Bay, WI 54304 USA  
800-360-4634

Date: 12/22/09

Page Number: 11

# TF System®

## 2 1/2" Poly Corner Set Dimensions

	System Width	Typical Length of Outside Leg (a)	Specialty corner sets for any angle can be ordered
90° Corner Sets	6"	12 5/8"	
	8"	14 5/8"	
	10" NOMINAL	16 1/8"	
	12" NOMINAL	18 "	
45° Corner Sets	6"	6 1/8"	
	8"	6 15/16"	
	10" NOMINAL	7 9/16"	
	12" NOMINAL	8 5/16"	



**Polystyrene Corner Sets**

**2 1/2" Thick**

TF System®  
3030C Holmgren Way  
Green Bay, WI 54304 USA  
800-360-4634

Date: 12/22/09

Page Number: 12

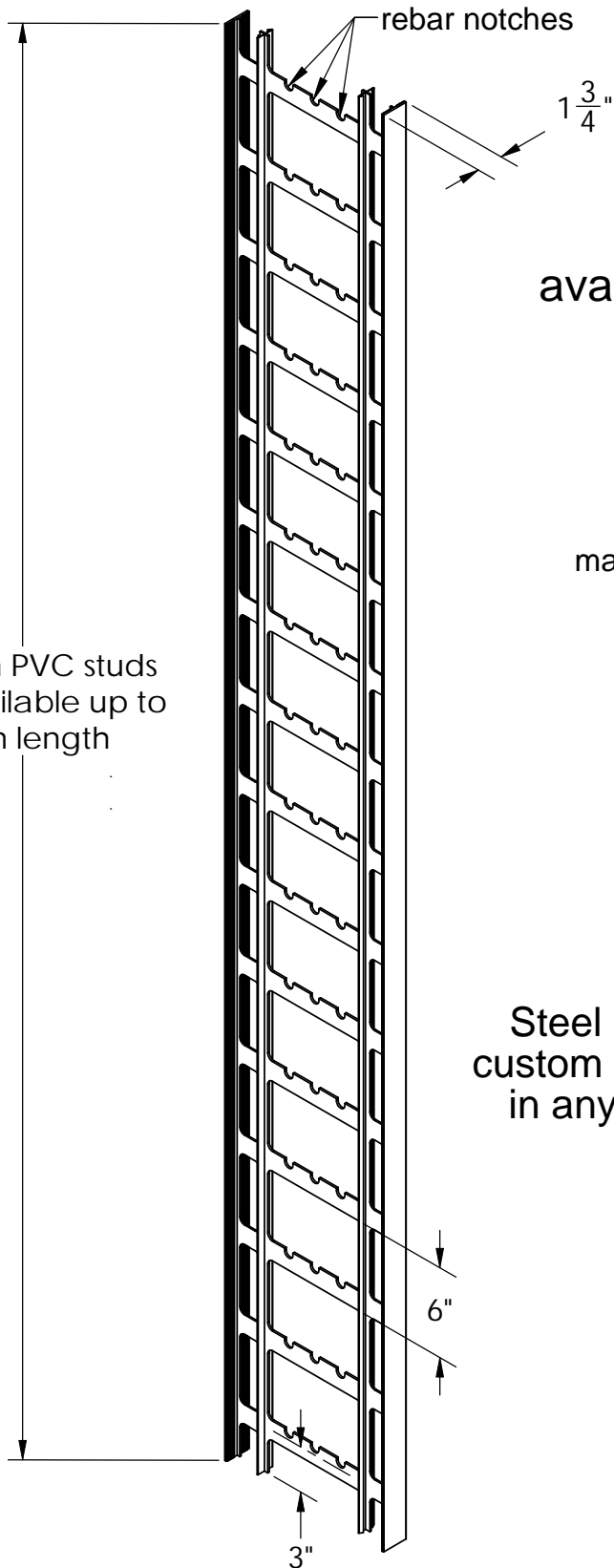

## Rigid PVC Studs

available in 6", 8", & 10" wall widths

Stock sizes can be cut to any height in the factory or on the jobsite.

made from 100% recycled rigid PVC

Steel studs can be fabricated for custom wall sizes; they are available in any wall widths from 4" to 24".



Plastic Studs

TF System®  
800-360-4634  
[www.TFSystem.com](http://www.TFSystem.com)

Date: 9/22/2009

Page Number: 13

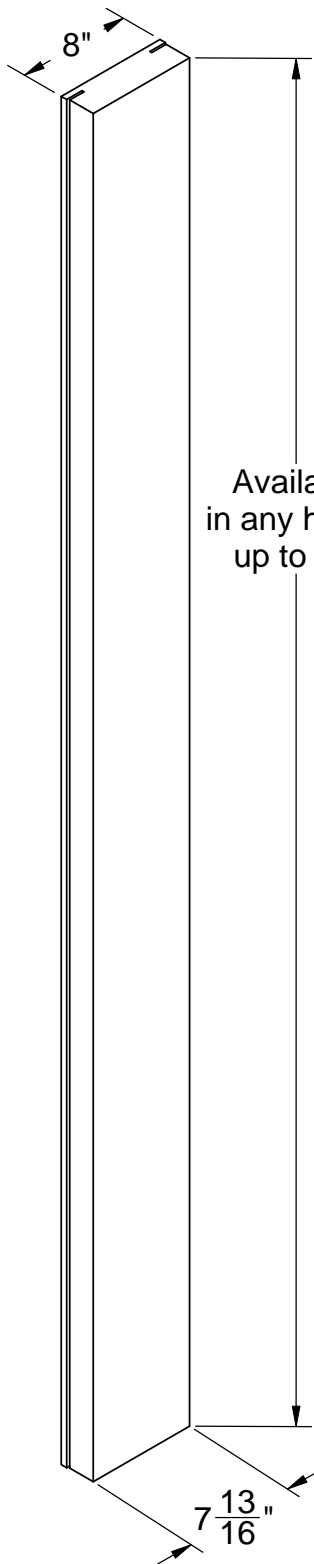

Standard polystyrene panels are 8" wide.

We can provide custom panels of differing thicknesses up to 4" and heights up to 12'.

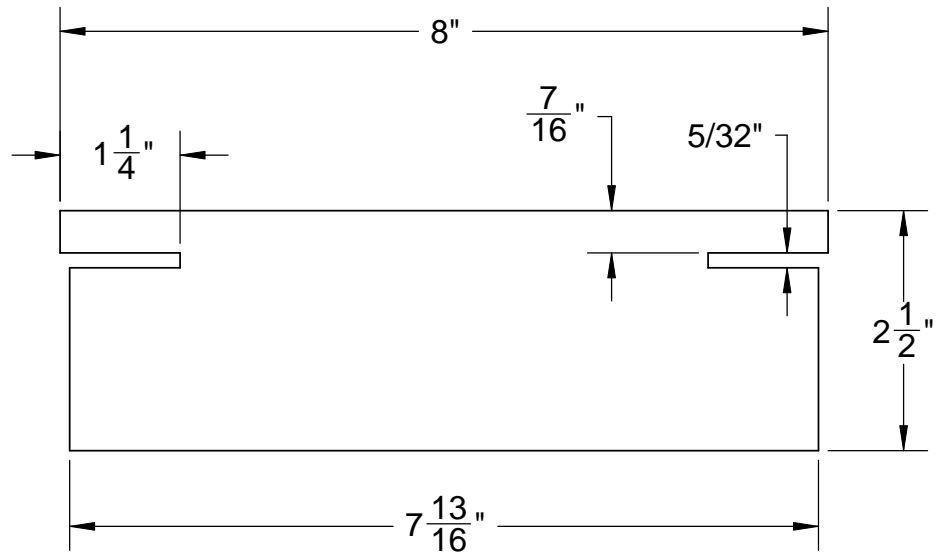

nominal density 1.5 lb/cubic ft

R = 4.76 per inch @ 25 °F  
 R = 4.55 per inch @ 40 °F  
 R = 4.17 per inch @ 75 °F

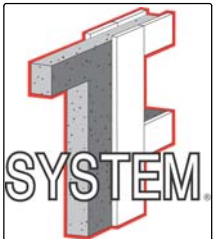

Standard Polystyrene Panels

TF System®  
 800-360-4634  
 www.TFSystem.com

Date: 11/25/2009

Page Number: 14

stock C-channel

8' or 10'

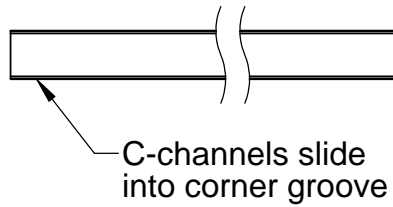
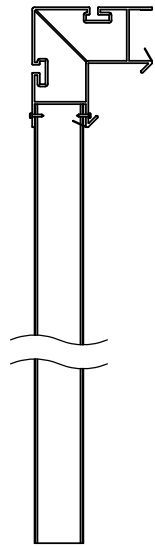
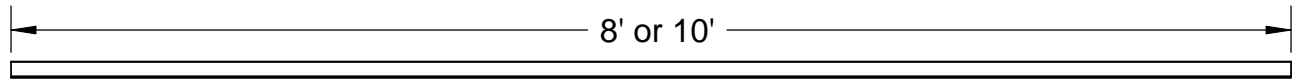

C-channels slide into corner groove

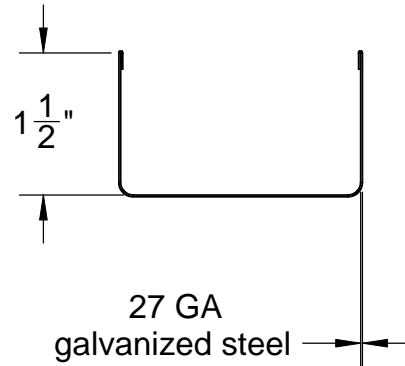

## 90° Corners

## non 90° corners

Cut and remove inner tab

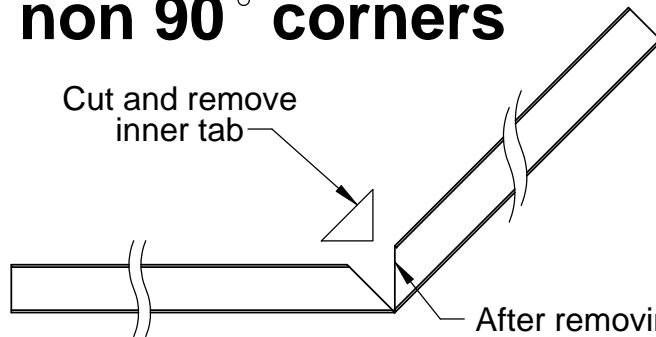

After removing the inner tab, bend channel to make desired corner angle

**CAUTION**  
**Cut edges are very sharp!**



C-channel

TF System®  
800-360-4634  
www.TFSystem.com

Date: 11/25/2009

Page Number: 15

**Taper top panels are used where additional load bearing surfaces are needed - some examples are shown here.**

2 x 4 Garage Walls

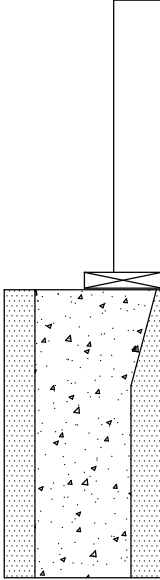

Gable End Truss Bearing

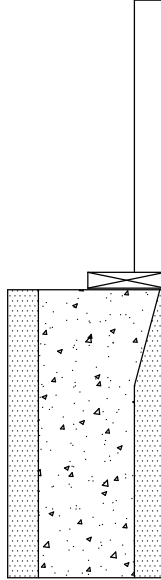

Brick Ledges

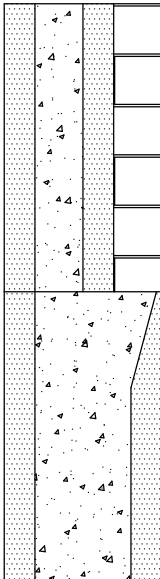

Floor Joist Ledges

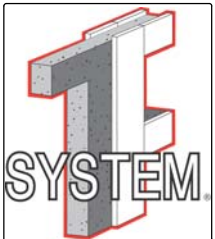
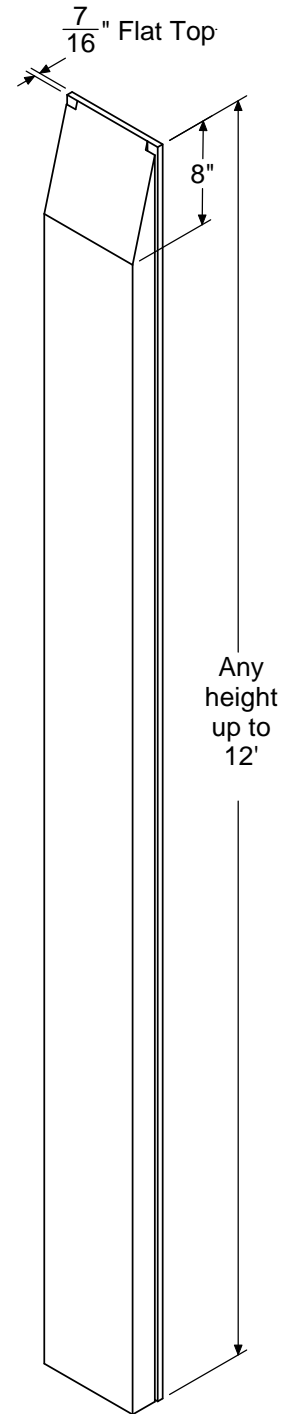
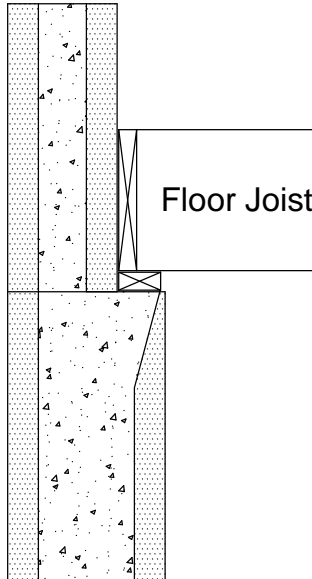

Taper Top Panels

TF System®  
800-360-4634  
www.TFSystem.com

Date: 9/24/2009

Page Number: 16



available in  
8' lengths

available in  
6", 8", 10" and 12"  
nominal wall cavity sizes

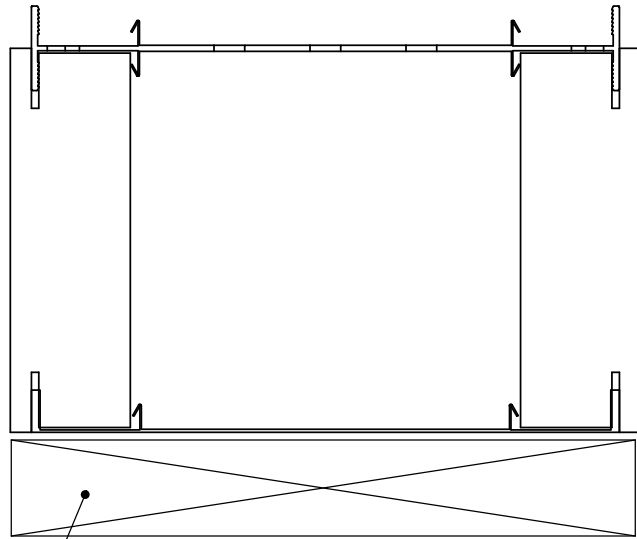

Rough opening lumber attaches to shut-off stud. Since the rough framing does not come into contact with concrete, treated lumber is not necessary.

The Thermo-Form shut-off stud is an economical way to close off a section of wall for various reasons, such as door and window openings, steps in the wall height, or the end of a wall run.

made from 100% recycled PVC

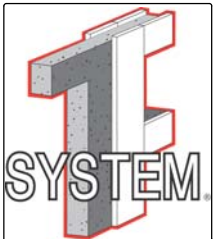

Shut-off Stud

TF System®  
800-360-4634  
www.TFSystem.com

Date: 11/25/2009

Page Number: 17

