

Section 3

Construction Techniques

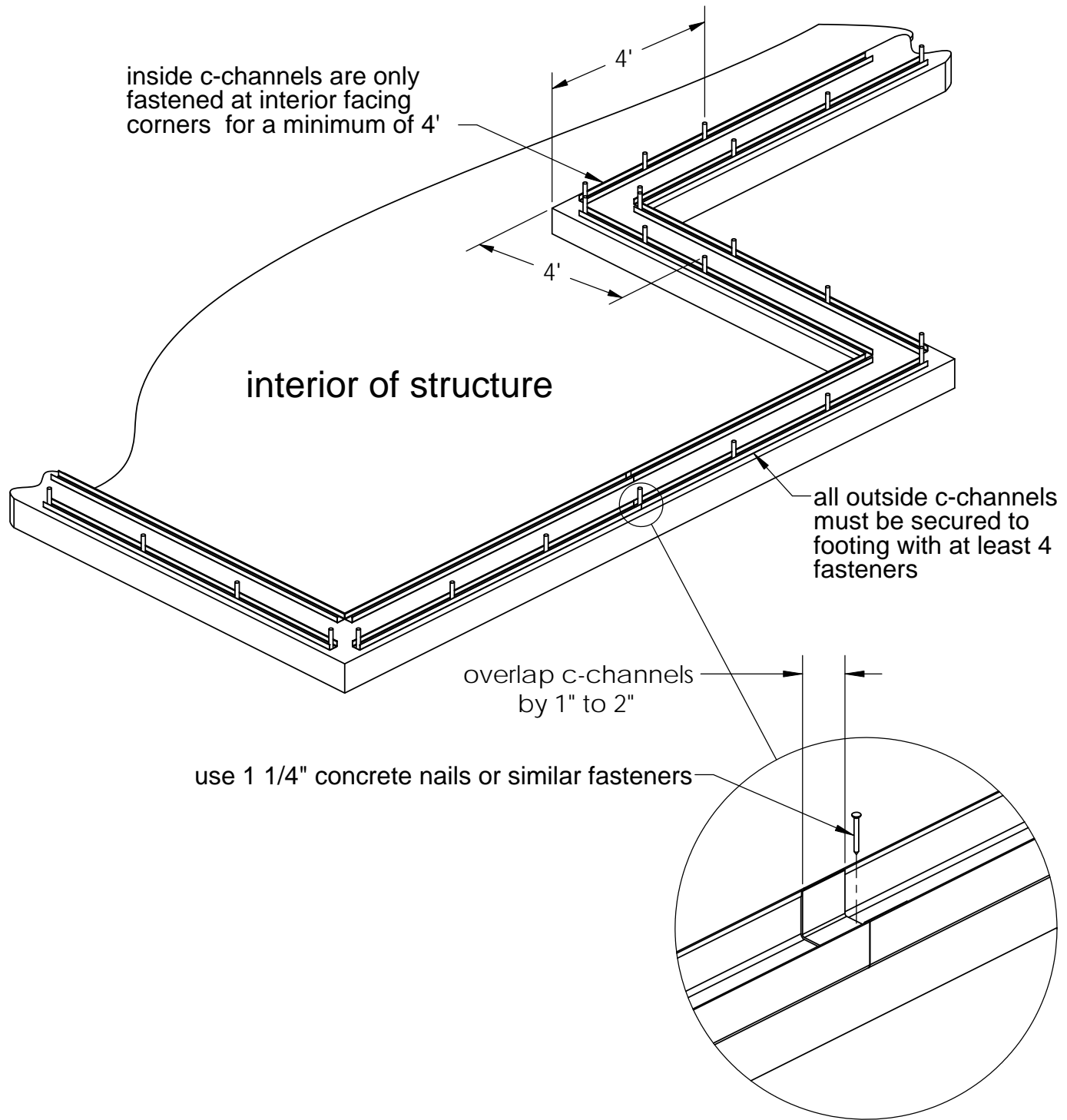

Lower C-channel Mounting

TF System®
 800-360-4634
 www.TFSystem.com

Date: 11/25/2009

Page Number: 21

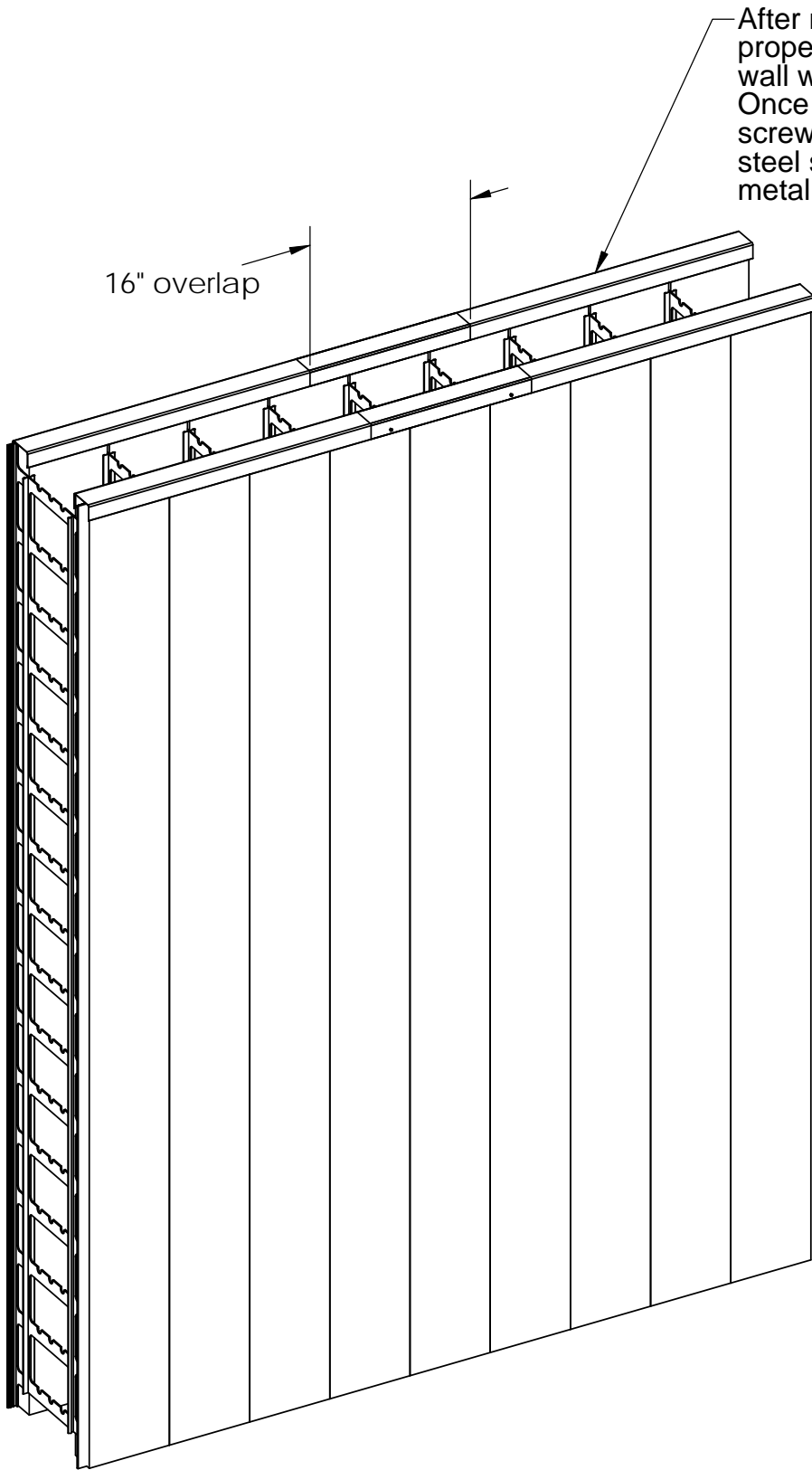

After mounting c-channel with proper overlap, straighten wall with string line. Once wall is straightened, screw channels together with steel stud screws or sheet metal screws.

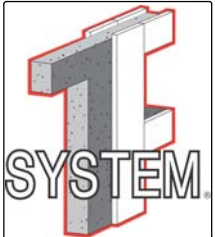

Upper C-channel Mounting

TF System®
800-360-4634
www.TFSystem.com

Date: 11/30/2009

Page Number: 22

Thermo-Form
wall shut-off stud

Place felt-paper over top buck.

Top buck should rest on side bucks.

Embed anchor bolts according to code.

Use treated or untreated
lumber with the wall
shut-off stud. Check
applicable codes.

Build up to the door
opening, install a splice
panel as needed, and
install door buck.

The wall shut-off stud is
used as a shoulder stud,
and should be installed on
each side of the opening.



Door Installation

TF System®
800-360-4634
www.TFSystem.com

Date: 11/30/2009

Page Number: 23

Window bucks may be assembled ahead of time for increased speed and efficiency at the job site

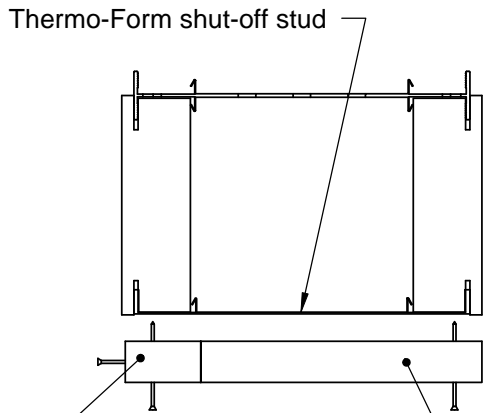

A furring strip may need to be used to fill out the window cavity for 8" or larger wall systems

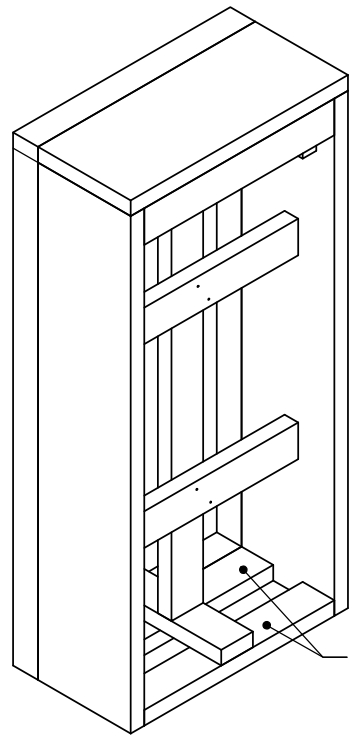

Rip lumber to fit the overall width of the system when using 4" & 6" wall systems

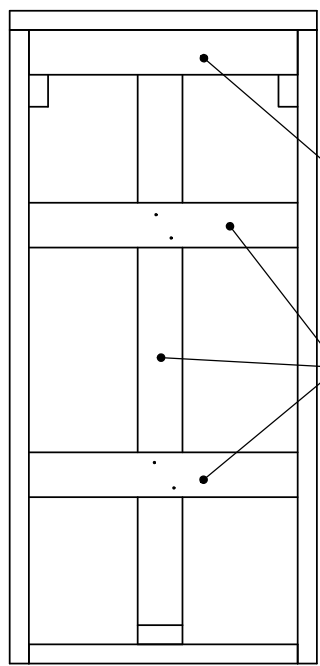

Installing header bracing at this time will help keep window square

Center bracing must be in place before pouring the wall

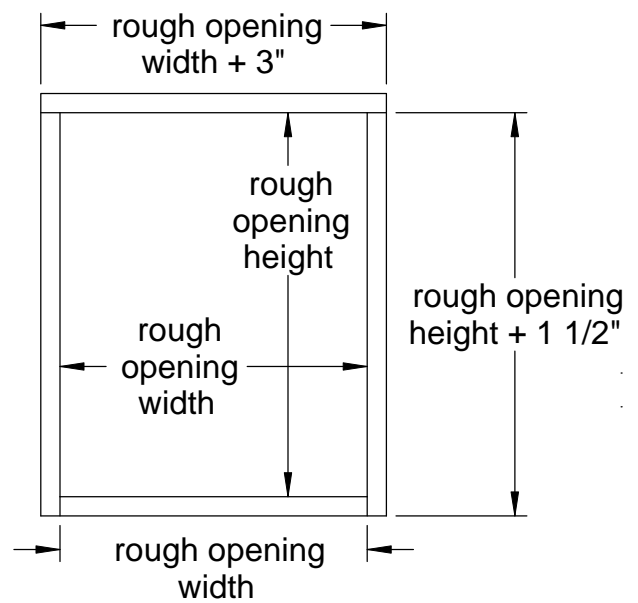

This method of window buck construction is dependent on using shut-off studs



Window Bucks

Using Thermo-Form Shut-off Stud

TF System®
800-360-4634
www.TFSystem.com

Date: 12/1/2009

Page Number: 24

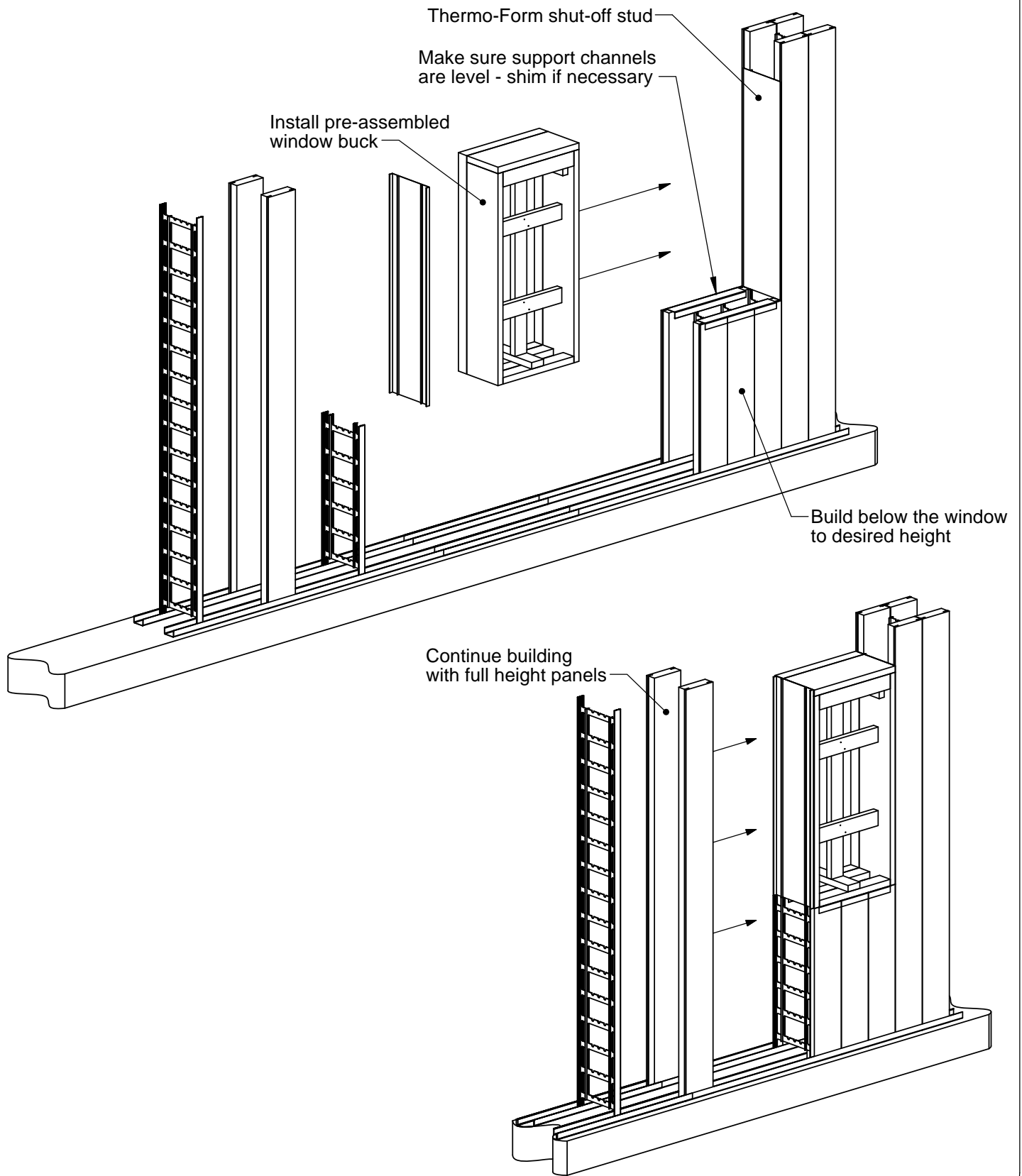

Window Installation

TF System®
 800-360-4634
www.TFSystem.com

Date: 11/25/2009

Page Number: 25

Vertical Header Method

Use this method for headers greater than 8" in height

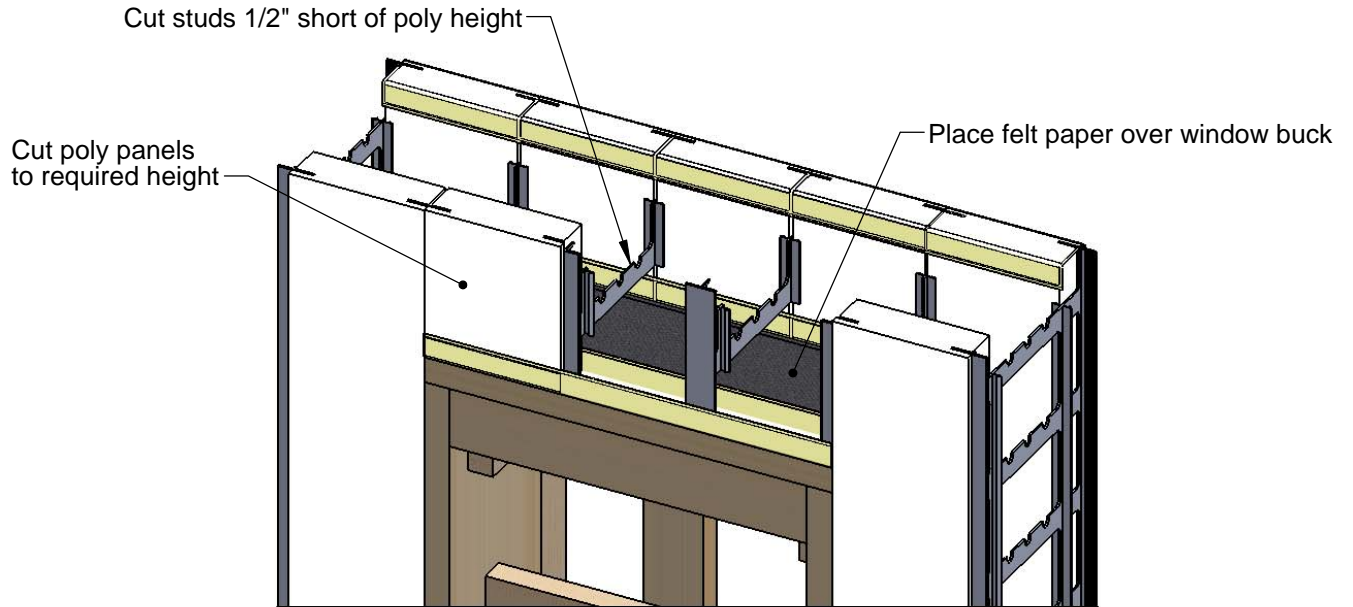

Horizontal Header Method

Use this method for headers less than or equal to 8" in height

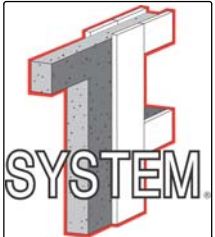
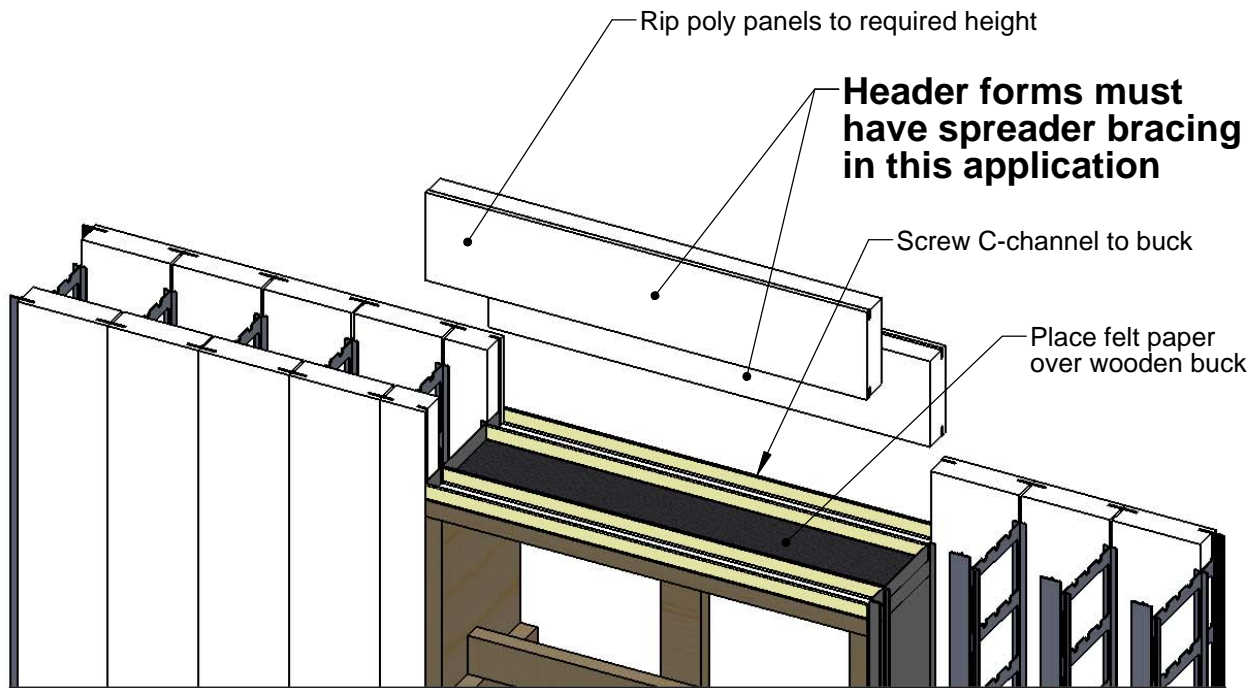

Window and Door Headers

TF System®
800-360-4634
www.TFSystem.com

Date: 11/25/2009

Page Number: 26

Thermo-Form stud with half flanges cut off

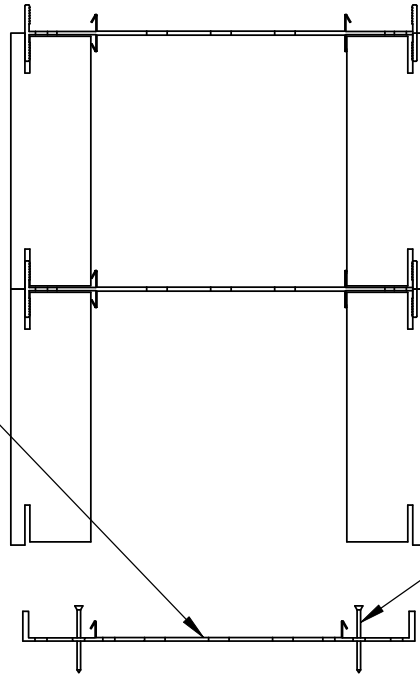

Use 1 5/8" coarse thread coated drywall screws spaced 12" vertically

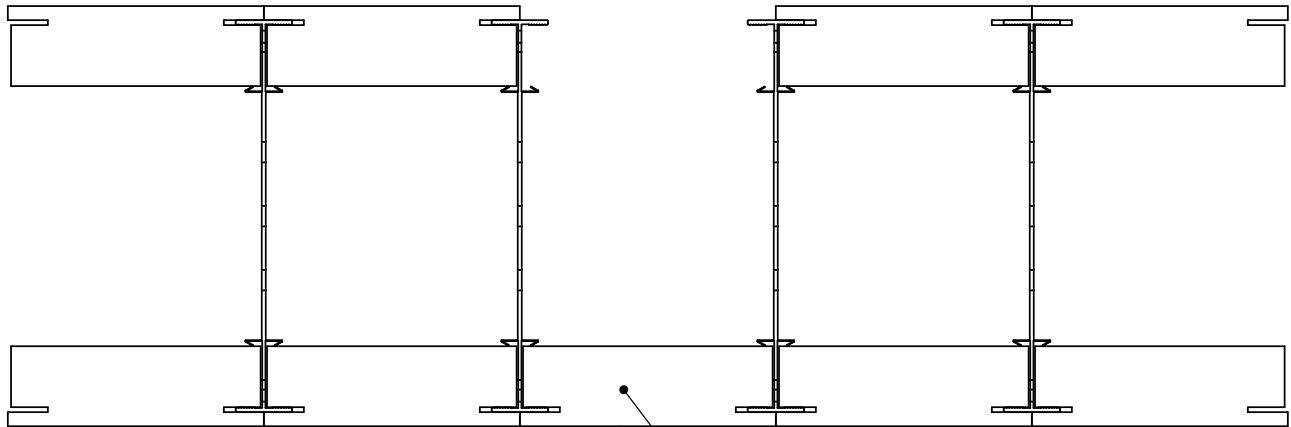

Brace and plumb this surface before attaching the stud of the intersecting wall

For walls smaller than 8" rip this splice panel to the same width as the intersecting wall cavity

For 10" or wider walls this piece must be specially ordered



T Intersection Top View

TF System®
800-360-4634
www.TFSystem.com

Date: 11/25/2009

Page Number: 27

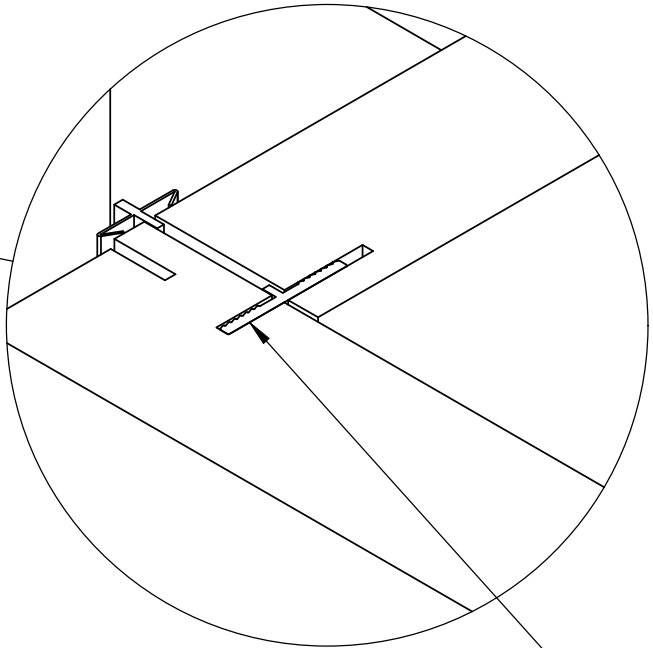
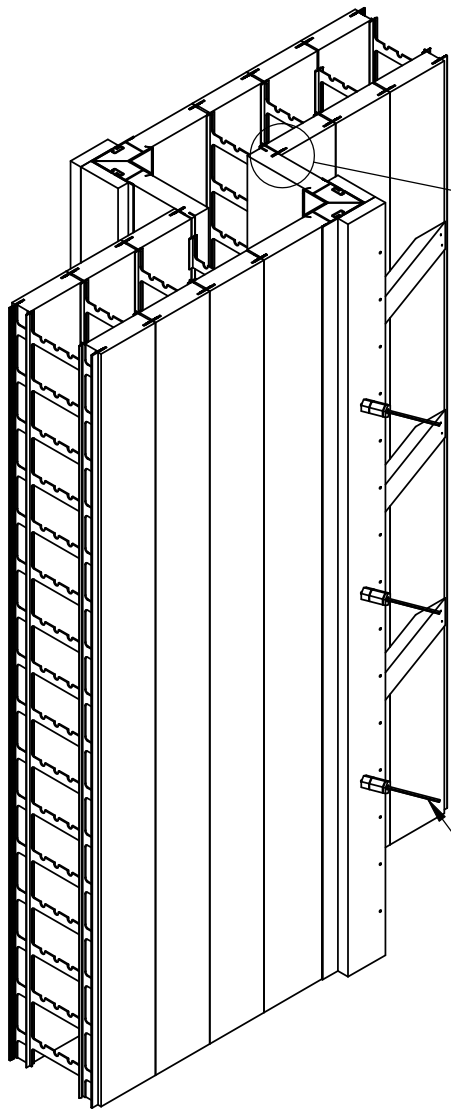

Groove face of poly corner panel to fit stud flange

Threaded Rod or SuperTie™
 SuperTie is a registered trademark of RJD Industries, INC.

**When placing concrete,
 pour in this area first**

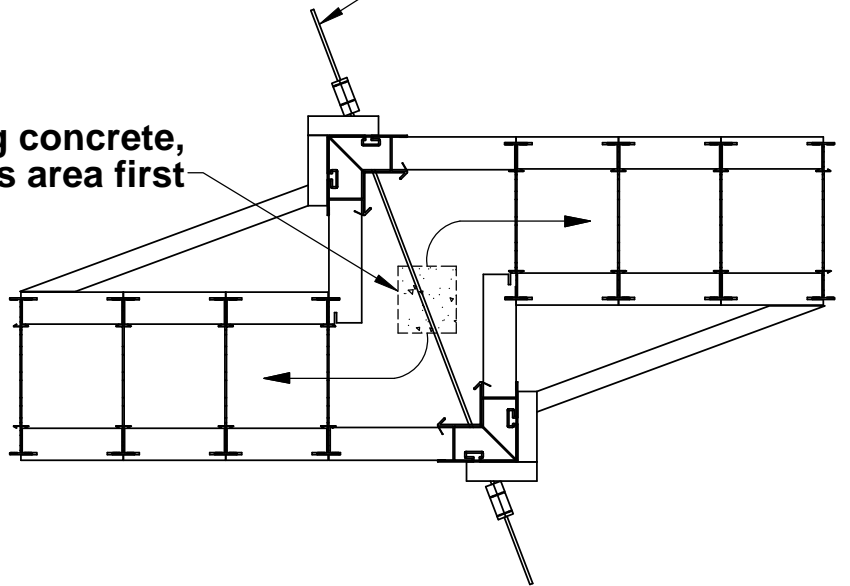

Offset Wall

TF System®
 800-360-4634
 www.TFSystem.com

Date: 11/30/2009

Page Number: 28

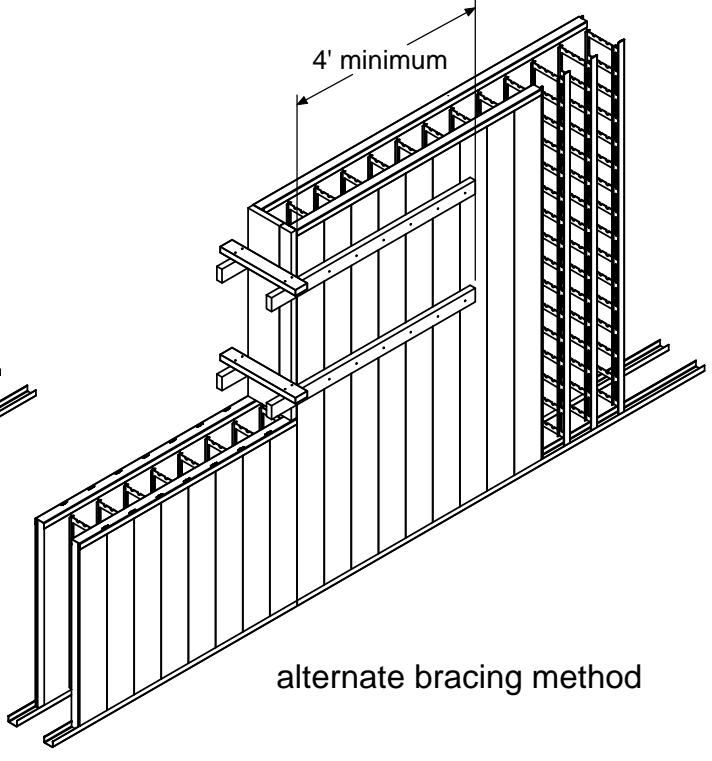
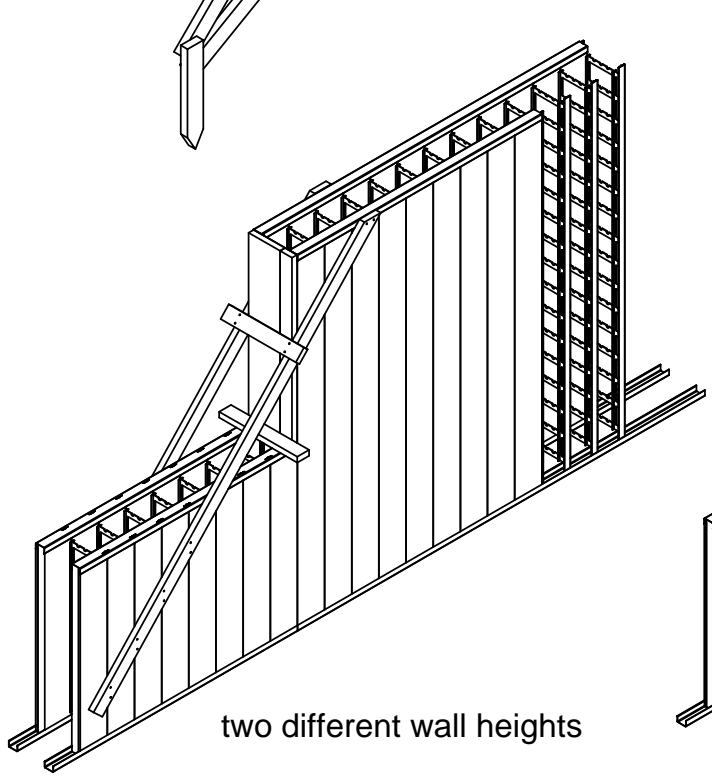
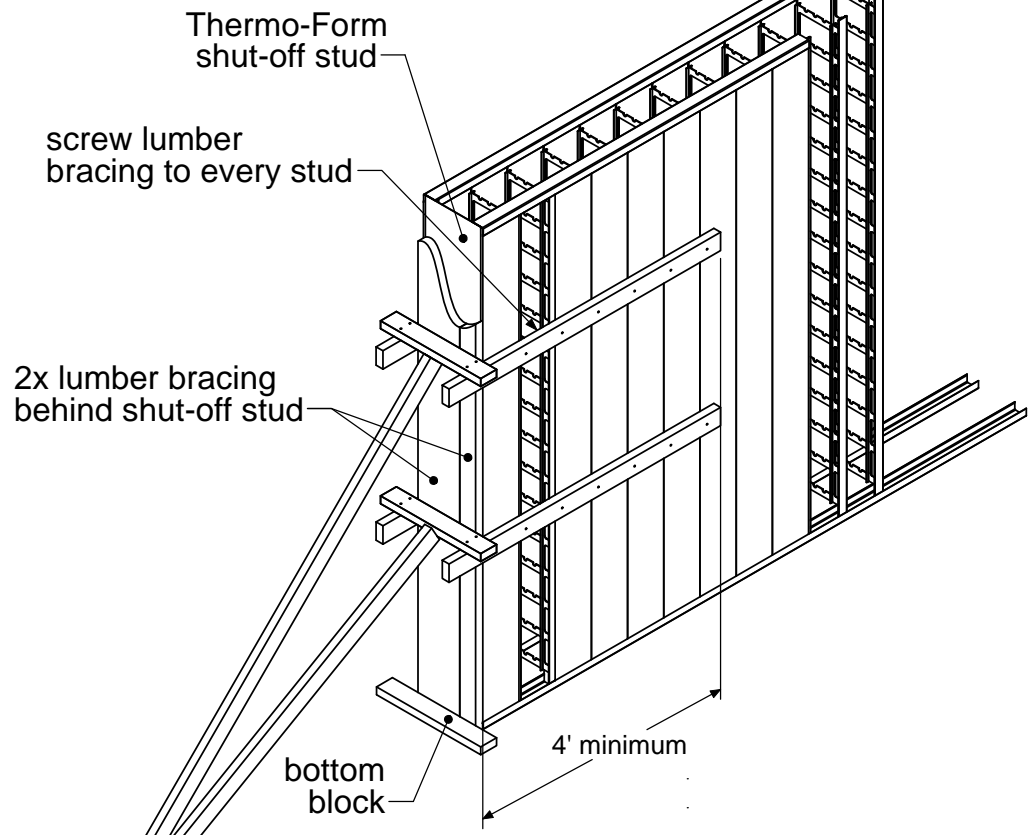

Wall End Closures



TF System®
 800-360-4634
 www.TFSystem.com

Date: 11/25/2009

Page Number: 29

Assemble outside poly panels and I-beams in desired radius first.

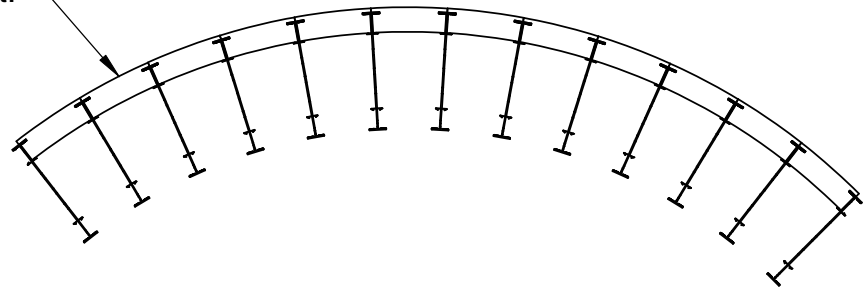

Brace with kickers as needed to hold the desired curvature.

Rip and groove inside poly panels to fit.

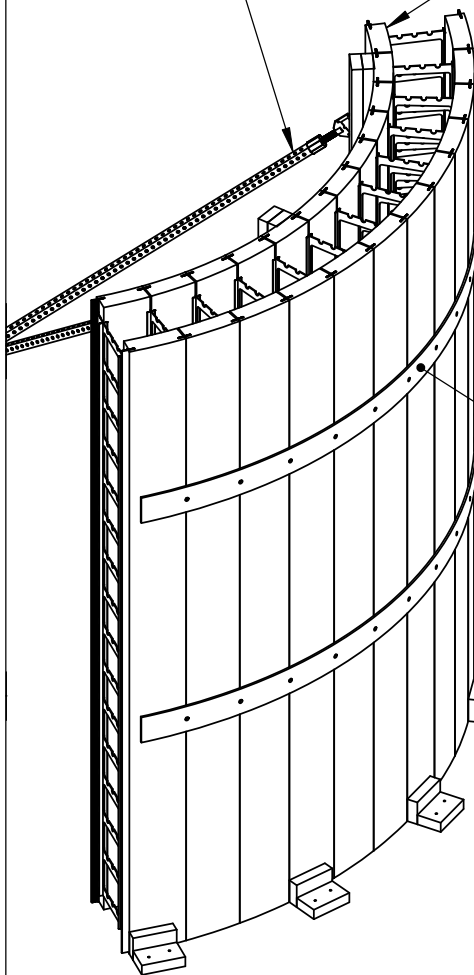

Panels may be beveled to achieve a tighter radius.

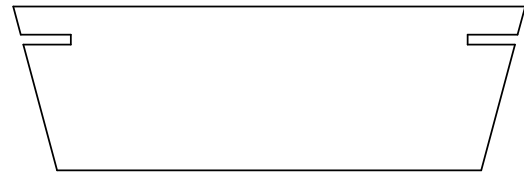

Brace with 1/4" masonite or thin strips of plywood. Do not use C-channel on the top or bottom.

Nail blocks to the footing as needed to hold the desired curvature.

Curved panels can be custom made for walls with tight radius. Contact TF System® for details.

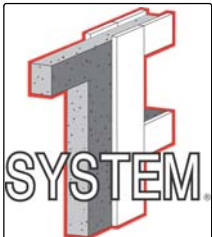
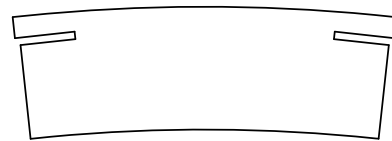

Round Walls

TF System®
800-360-4634
www.TFSystem.com

Date: 10/28/2009

Page Number: 30

Slide panels up to pour the wall. This will limit the free fall of fresh concrete.

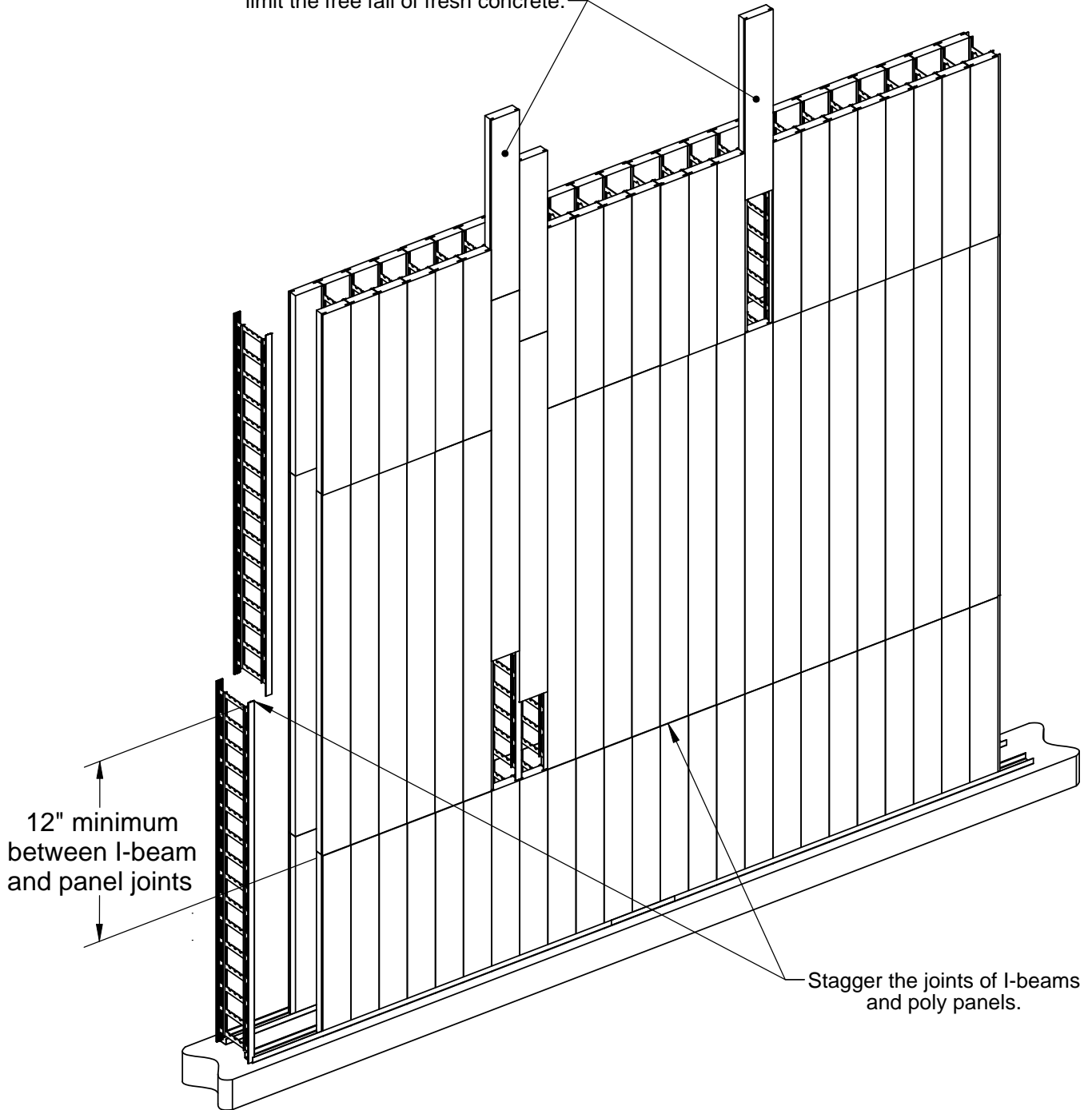

TF System® components can be stacked to heights greater than 12' provided they are sufficiently braced and properly reinforced.

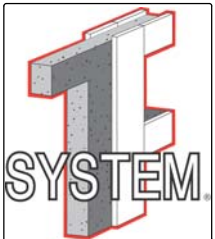

Tall Walls

TF System®
800-360-4634
www.TFSystem.com

Date: 11/25/2009

Page Number: 31

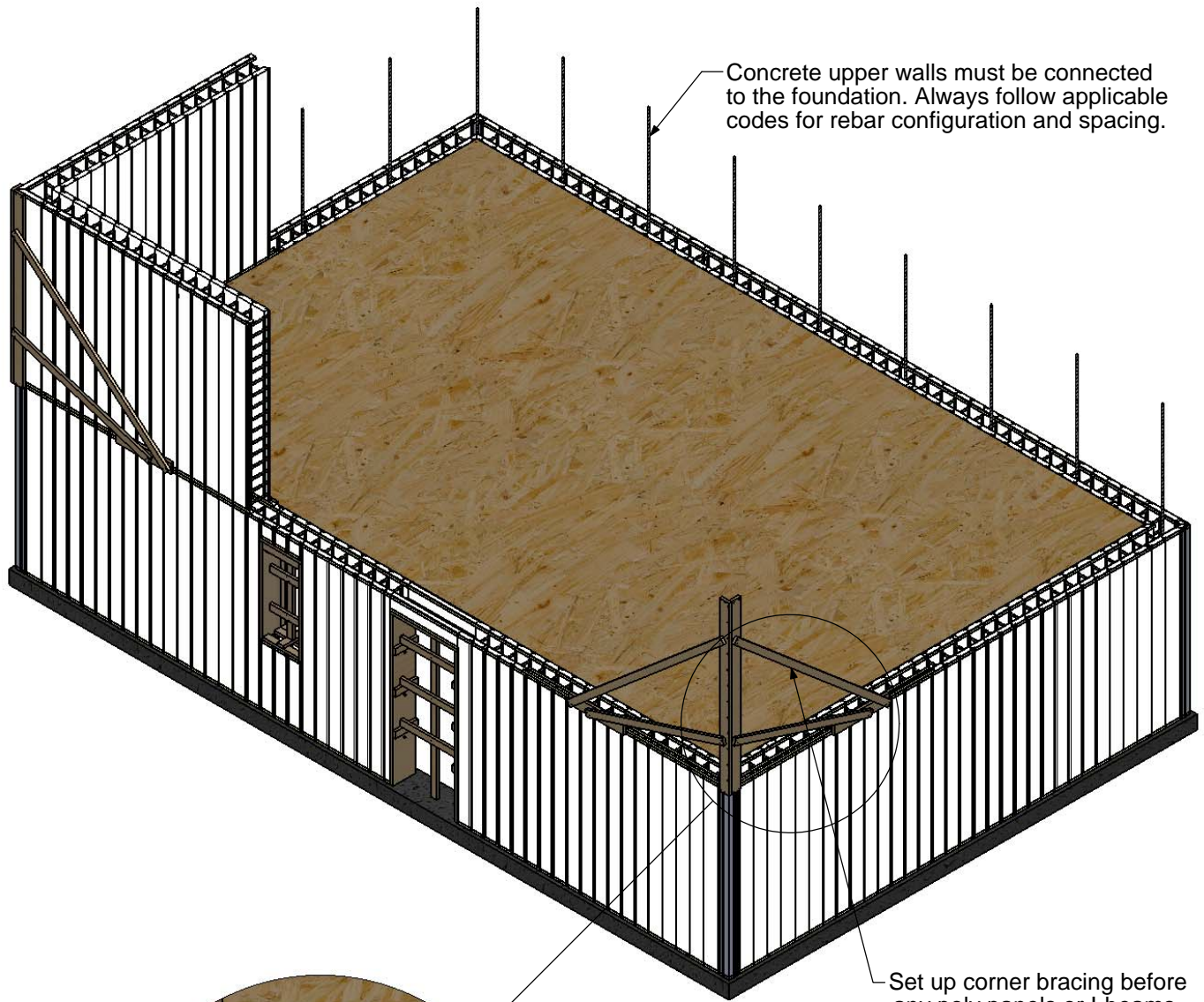

Concrete upper walls must be connected to the foundation. Always follow applicable codes for rebar configuration and spacing.

Set up corner bracing before any poly panels or I-beams.

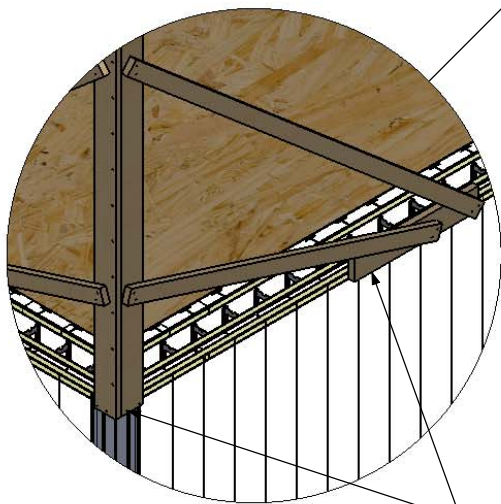

Screw corner braces through C-channel and stud rails.



Starting Upper Walls

TF System®
800-360-4634
www.TFSystem.com

Date: 10/1/2009

Page Number: 32

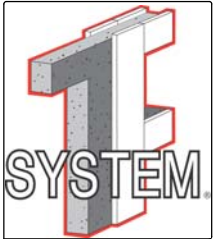
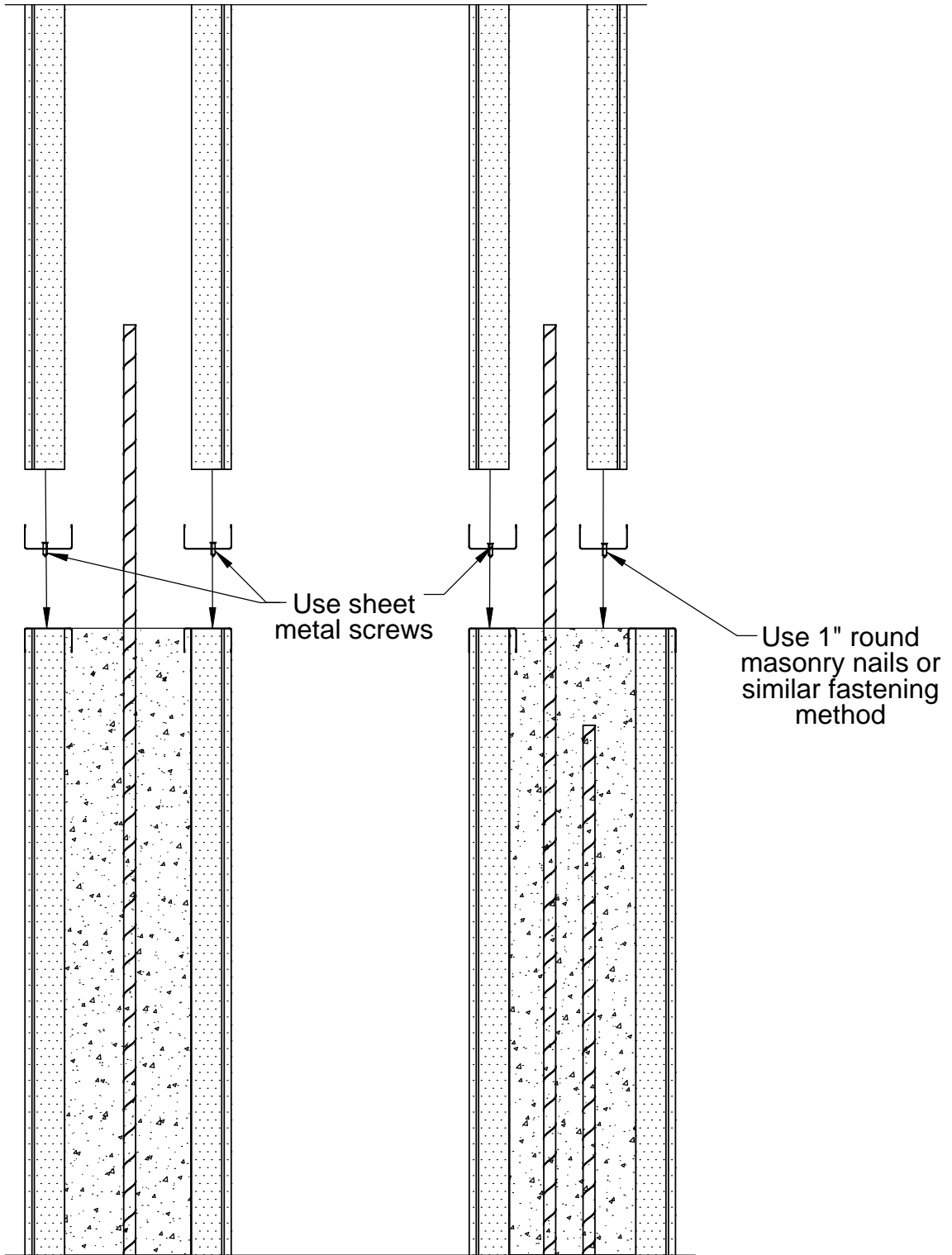

Placing C-channel
on Upper Walls

TF System®
800-360-4634
www.TFSystem.com

Date: 11/30/2009

Page Number: 33

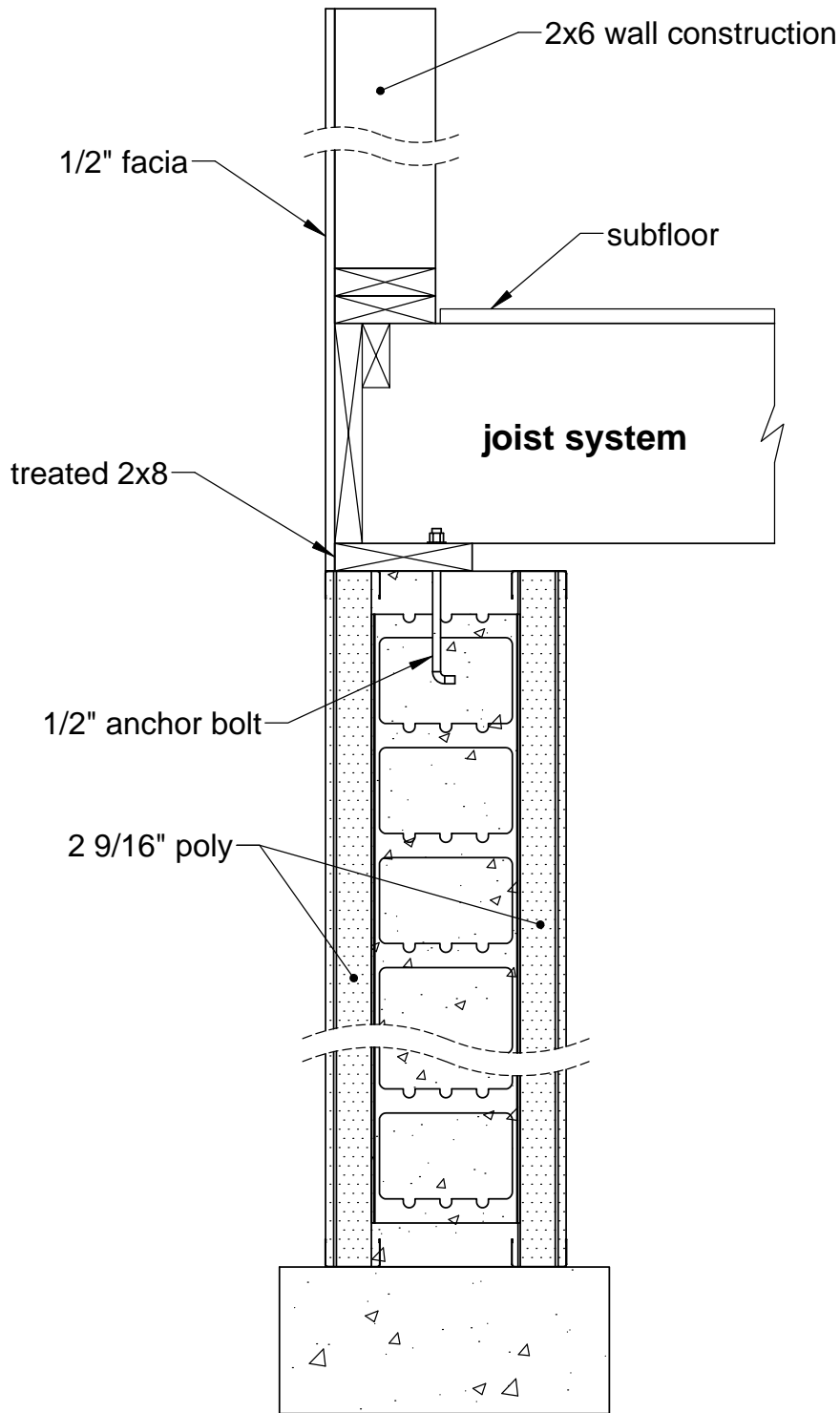

This method can be used with any Thermo-Form wall width

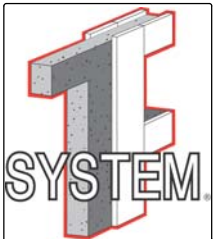

**Stick Wall above
Thermo-Form Wall**

TF System®
800-360-4634
www.TFSystem.com

Date: 12/1/2009

Page Number: 34

This method is valid for any combination of wall widths

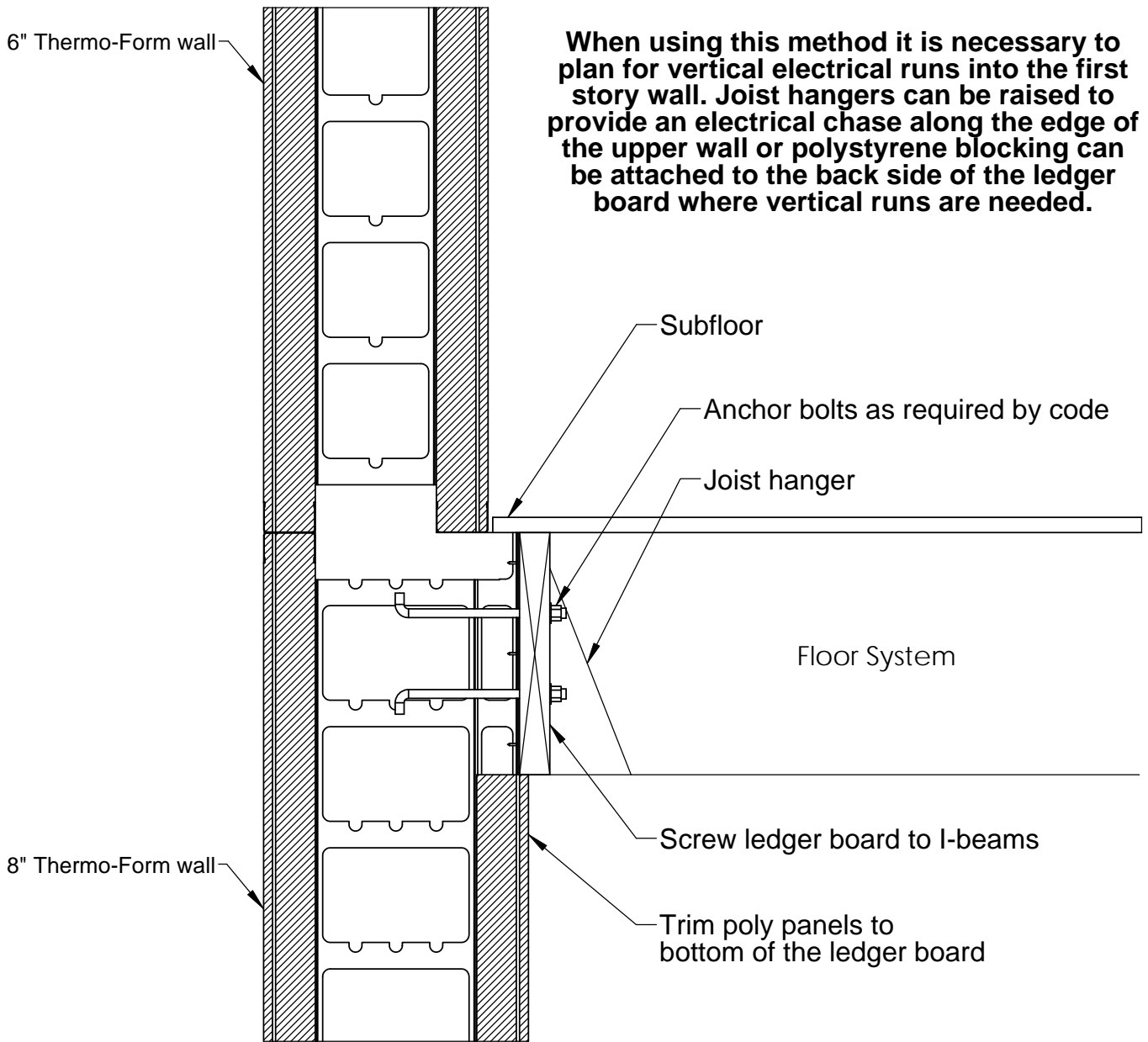

Ledger Board Detail

Any Combination of Wall Widths

TF System®
800-360-4634
www.TFSystem.com

Date: 12/2/2009

Page Number: 35

This method is valid for any combination of wall widths

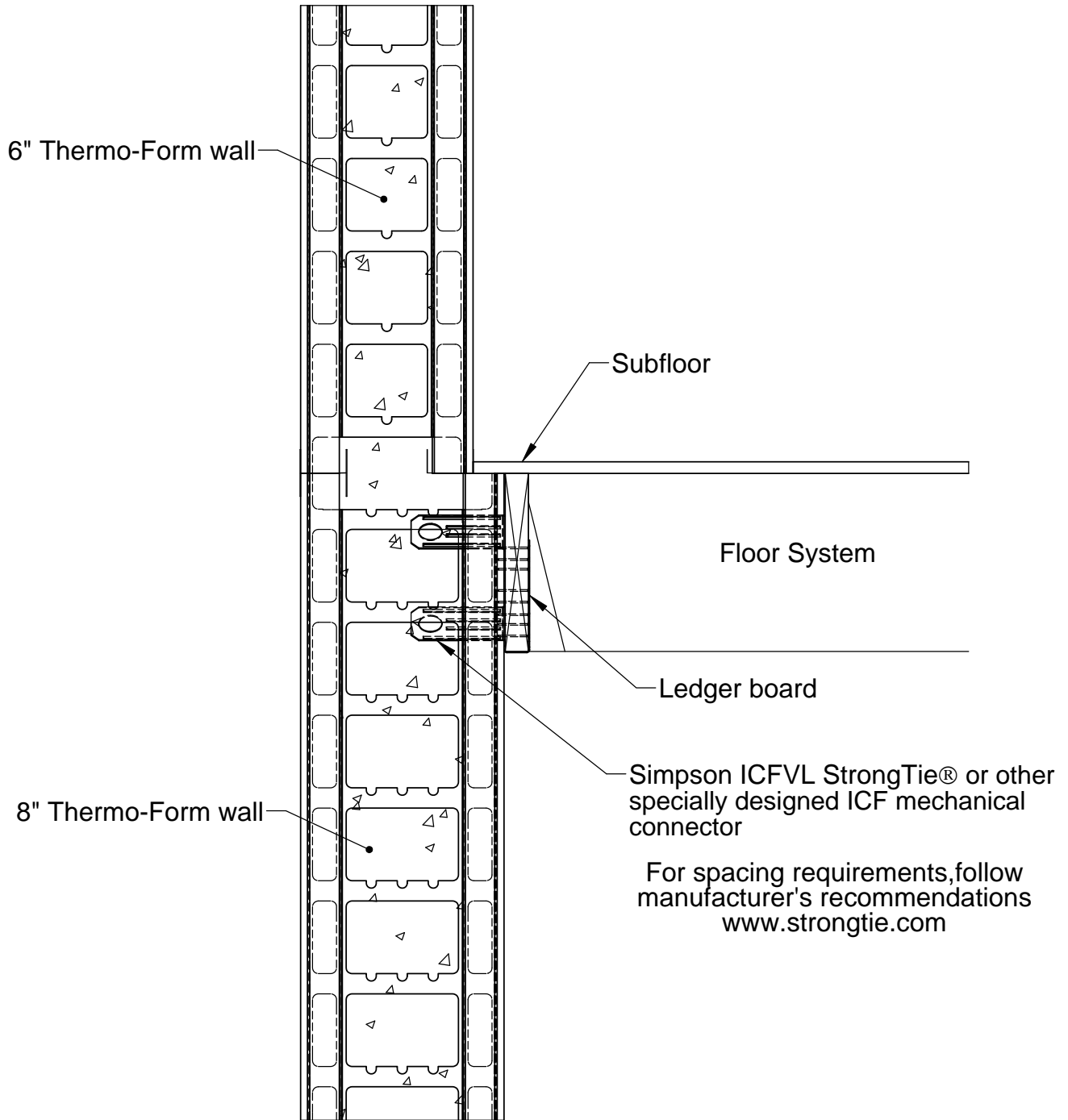

Ledger Board Detail

Using Simpson StrongTies

TF System®
800-360-4634
www.TFSystem.com

Date: 12/2/2009

Page Number: 36

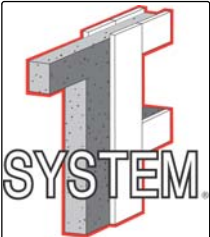
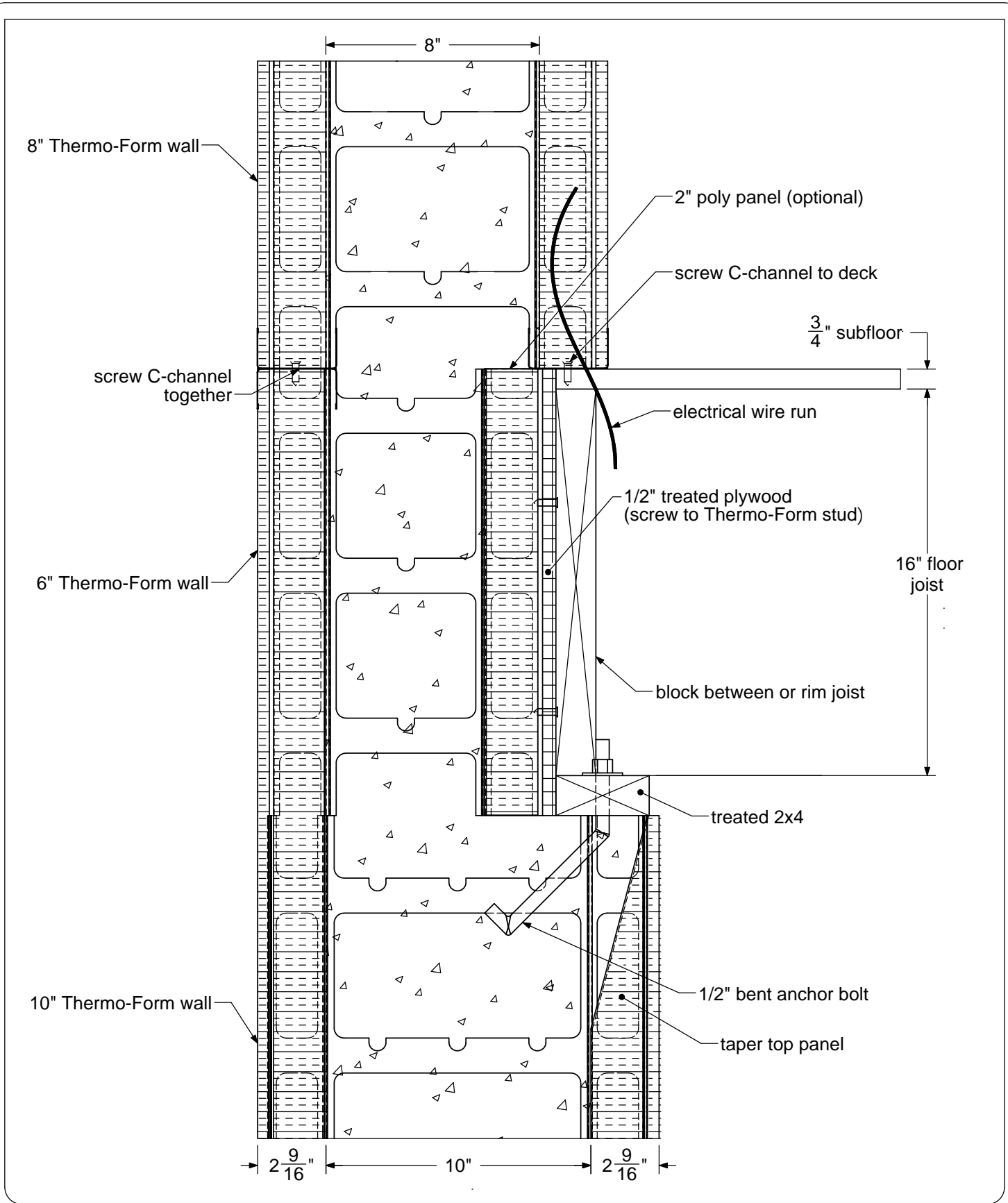

Bearing Ledge Detail

10" to 8" wall with 3 1/2" bearing

TF System®
800-360-4634
www.TFSystem.com

Date: 11/25/2009

Page Number: 37

This method is valid any time there is a 4" difference in wall widths between floors

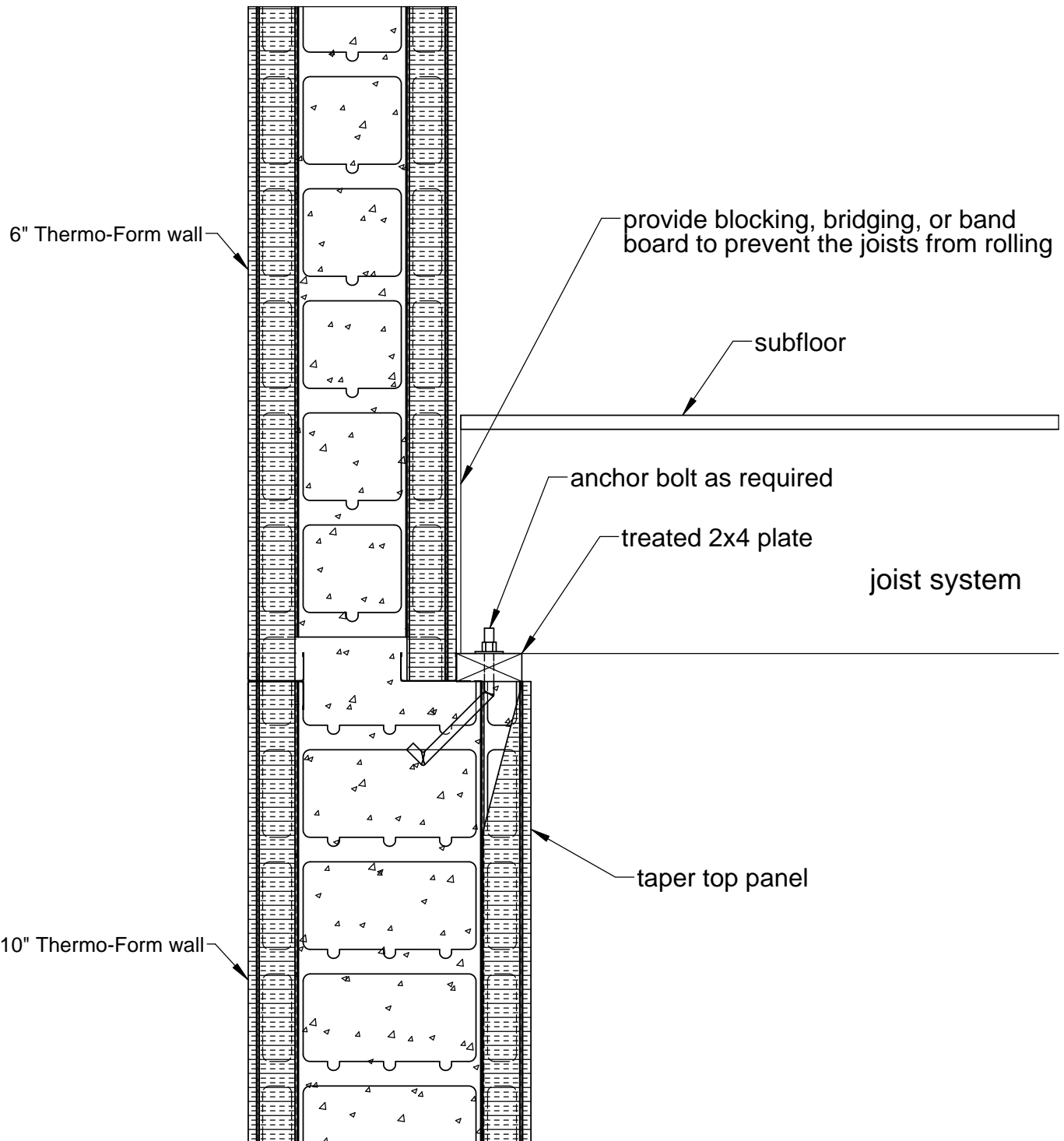

Bearing Ledge Detail

4" Difference in Width

TF System®
800-360-4634
www.TFSystem.com

Date: 11/30/2009

Page Number: 38

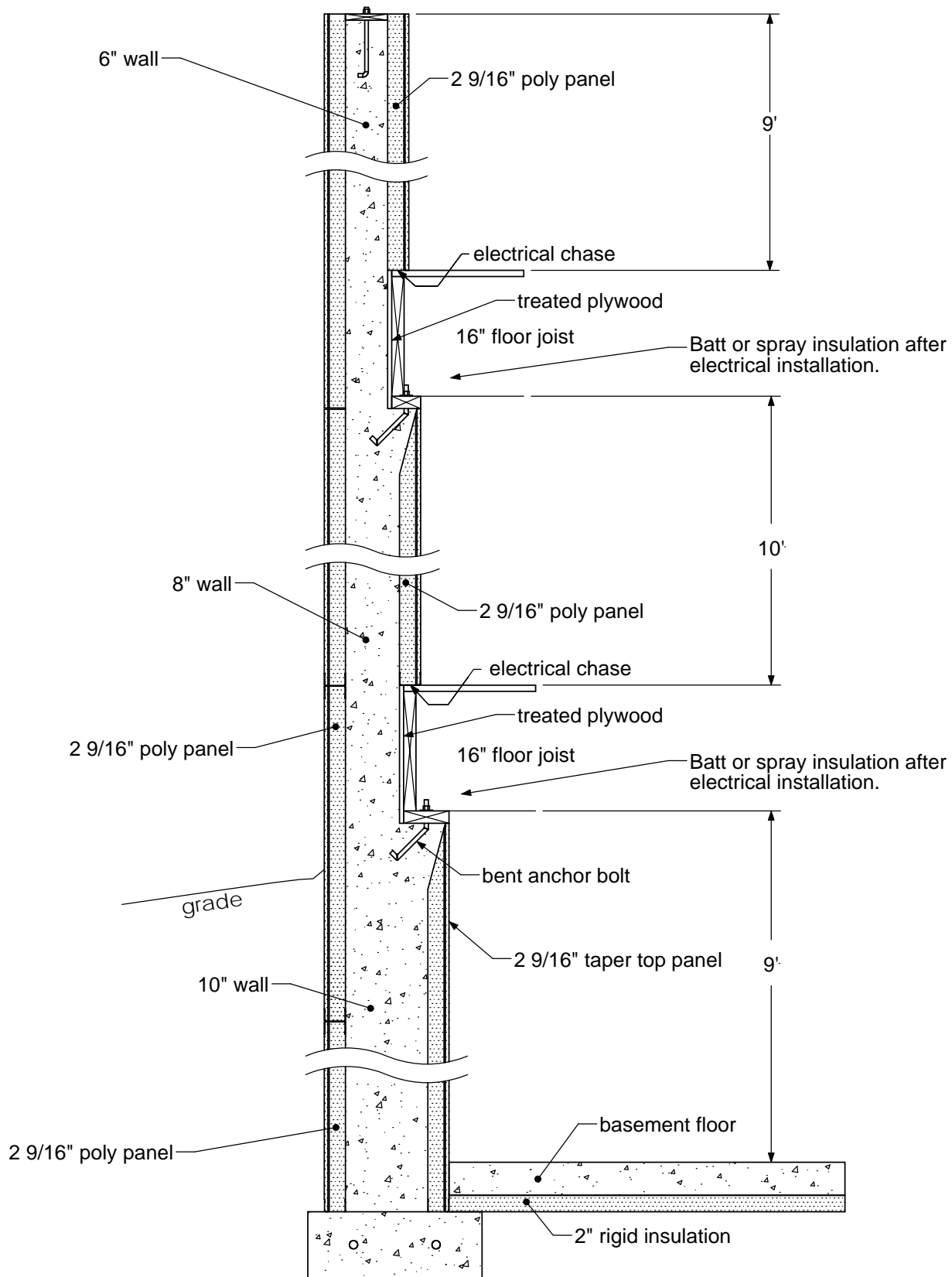

3 Story Thermo-Form Ledger

10" to 8" to 6" w/ Bearing

TF System®
 800-360-4634
 www.TFSystem.com

Date: 12/2/2009

Page Number: 39

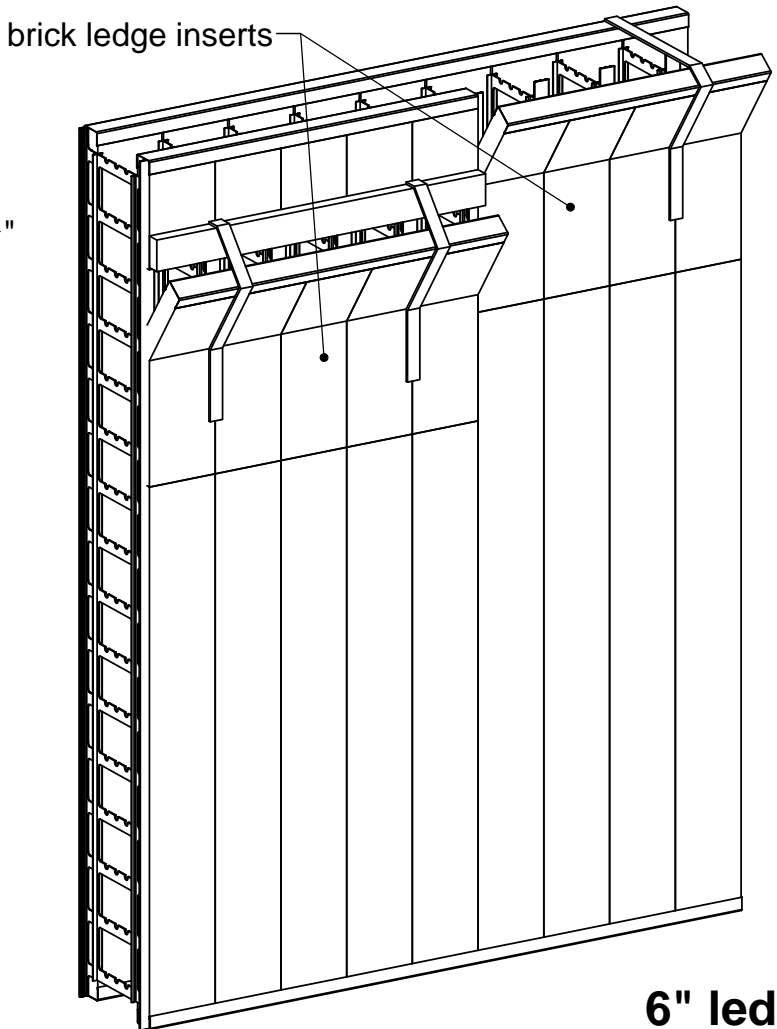
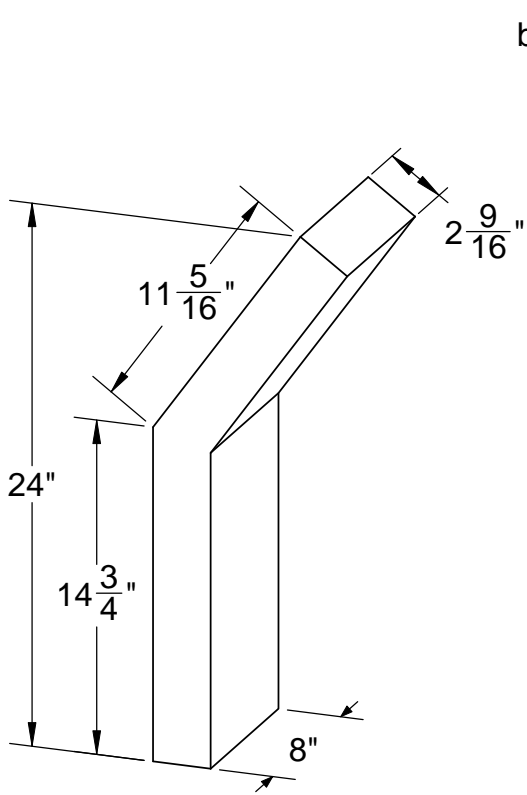

4" ledge

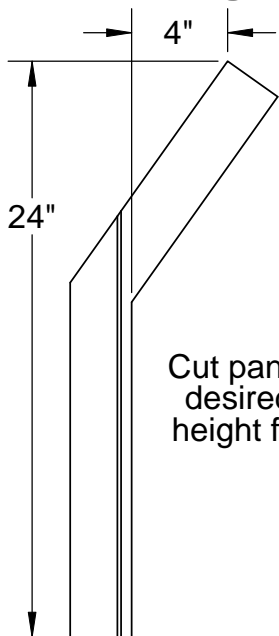

Cut panels 2' short of desired brick ledge height for a 4" ledge.

6" ledge

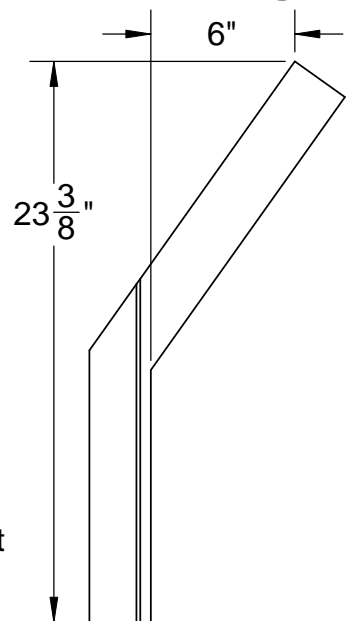

Cut panels 23-3/8" short of desired brick ledge height for a 6" ledge.

Brick ledge inserts may be flipped to produce either a 4" or 6" ledge. Inserts are assembled into wall in the same manner as standard panels.

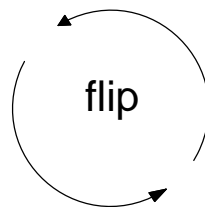

Brick Ledge Insert

TF System®
 800-360-4634
 www.TFSystem.com

Date: 12/2/2009

Page Number: 40

The two innermost brick ledge inserts are precut to fit around the inside corner piece. A small void is left and if desired can be filled in.

standard corner piece

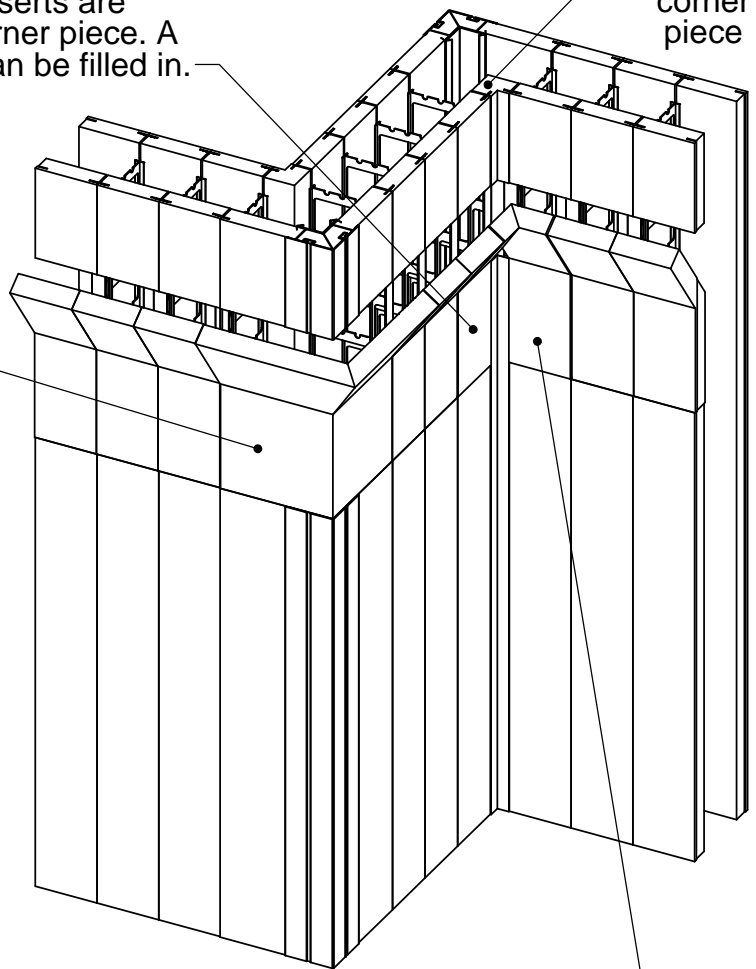

Outside corners come in two pieces and are assembled on site.

Made for 12" walls
Cut down in 2"
increments to fit
wall dimensions
as needed

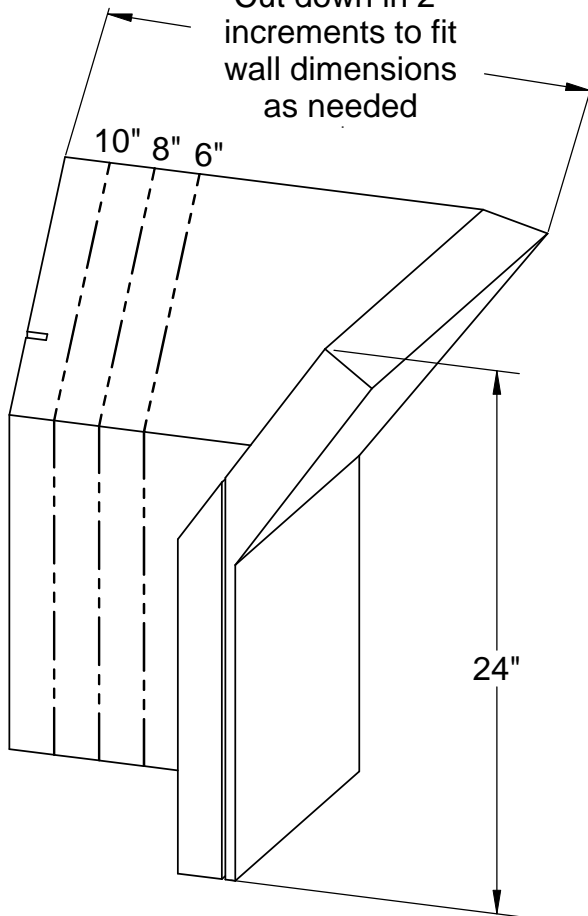

Inside corner comes in two pieces. They are precut and ready to install.

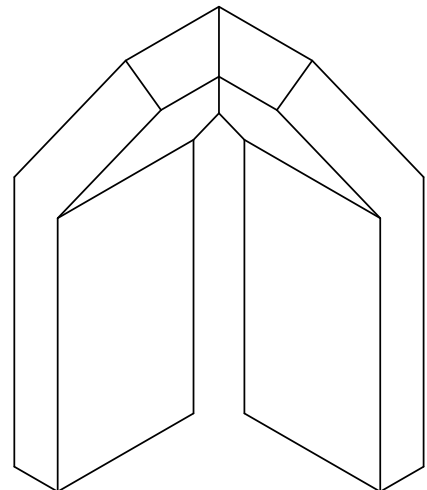

Brace all brick ledges well (see page 38)

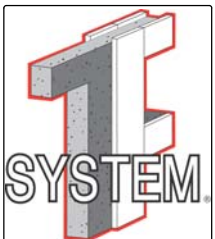

Brick Ledge Corners

Custom Ordered

TF System®
800-360-4634
www.TFSystem.com

Date: 12/2/2009

Page Number: 41

